

REV	DATE	DESCRIPTION	BY
A	9/1/2023	INITIAL RELEASE	KGH
B	2/26/2024	UPDATED PUMP PANEL, STANDARD OPTIONS, & DIMERS	KGH
C	11/20/2024	UPDATED LIGHT PACKAGE	KGH

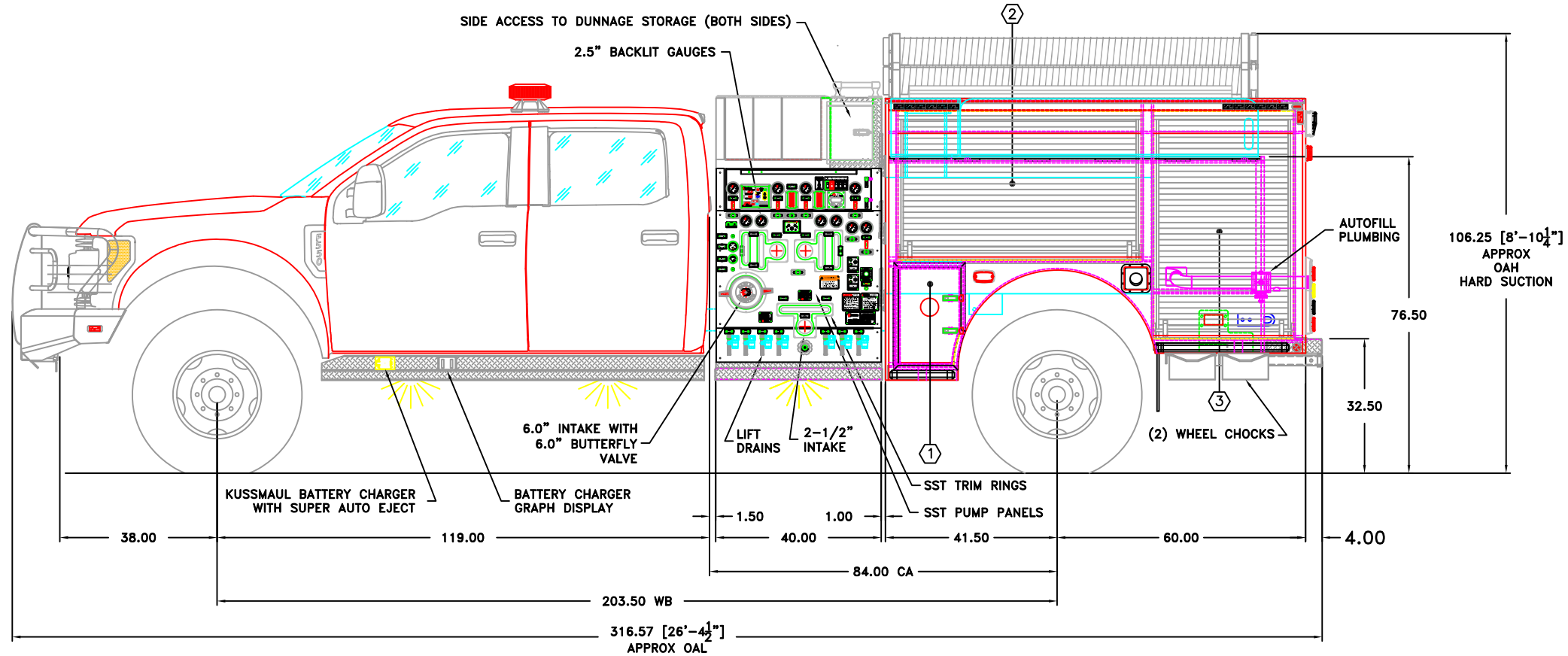

CHASSIS

MODEL	FORD	GVW	19,500
F-550		FRONT AXLE	7,500
4 X 4		REAR AXLE	14,706
		C/A	84.00
		WB	203.50
		ENG. TYPE	6.7L POWERSTROKE DIESEL

PUMP TYPE PSMC 1500 GPM SINGLE STAGE
TANK SIZE/TYPE 300 GAL WATER 25 GAL FOAM / POLY

COMPARTMENTS

MARK	SIZE	DOOR SIZE
1	15.25W X 23.88H X 20.50D	PAN DOOR
2	58.75W X 36.00H X 20.50D	58.75W X 34.00H
3	33.75W X 55.00H X 20.50D	33.75W X 53.00H

GENERAL NOTES

These drawings are the sole property of W.S. DARLEY & Co. These Drawings are for showing the concept of the apparatus being specified and therefore may not agree with the final contract. Not all items being specified are shown on these drawings. Refer to specifications for further details. These drawings are on loan and must be returned upon request of W.S. DARLEY & Co. or its authorized representative. This design is the property of W.S. DARLEY & Co. - unauthorized reproduction is prohibited. Chassis is Manufacturer's standard production model. Specifications are subject to change without notice. Dimensions shown are approximate, and subject to minor deviations as may occur or be necessary in construction. Minor details not shown. Where there may be nonconformity between the illustration and the sales order, the sales order and all approved sales order changes will prevail. DO NOT SCALE PRINTS. All dimensions shown are in decimal inches unless noted otherwise.

ABBREVIATIONS

COMMONLY USED ABBREVIATIONS IN DRAWINGS:
A/F - AFT FRAME COMP. - COMPARTMENT
W.B. - WHEEL BASE
C/A - CAB TO AXLE
OAL - OVERALL LENGTH
OH - OVERALL HEIGHT
GVW - GROSS VEHICLE WEIGHT
TYP. - TYPICAL
C.S. - CUSTOMER SUPPLIED
N.I.C. - NOT IN CONTRACT

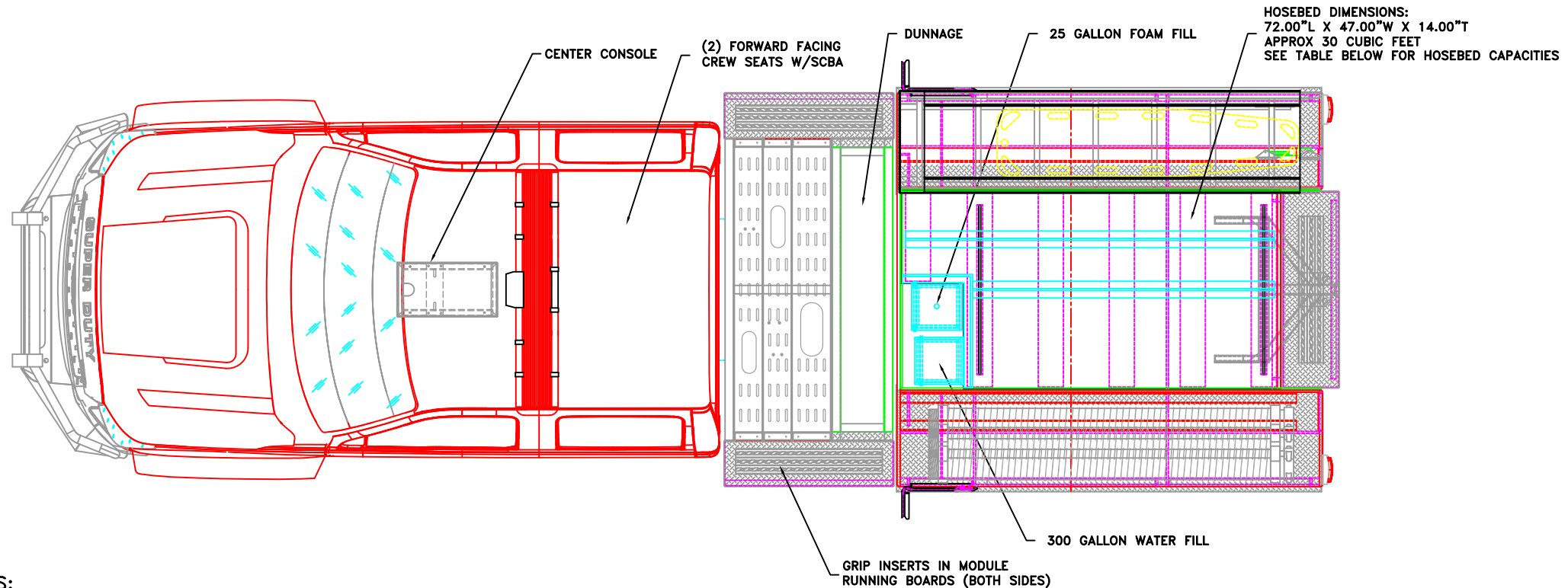

HOSE BED CAPACITIES:
1400 FT OF 2.0" HOSE, OR
1050 FT OF 2.5" HOSE, OR
850 FT OF 3.0" HOSE, OR
500 FT OF 5.0" HOSE

CUSTOMER APPROVAL SIGNATURE	DATE	REVISIONS
DARLEY APPROVAL SIGNATURE	DATE	DATE FEBRUARY 26, 2024
		SCALE 3/4" = 1'-0"
		QW BASE SPEC
		DRAWN BY K. HALOPKA
		CHECKED BY C. FEUSTER
		DWG FILE NAME 13001004
		JOB NO. MAX F550
		SHEET NO. 1

REV	DATE	DESCRIPTION	BY
A	9/1/2023	INITIAL RELEASE	KGH
B	2/26/2024	UPDATED PUMP PANEL, STANDARD OPTIONS, & DIMERS	KGH
C	11/20/2024	UPDATED LIGHT PACKAGE	KGH

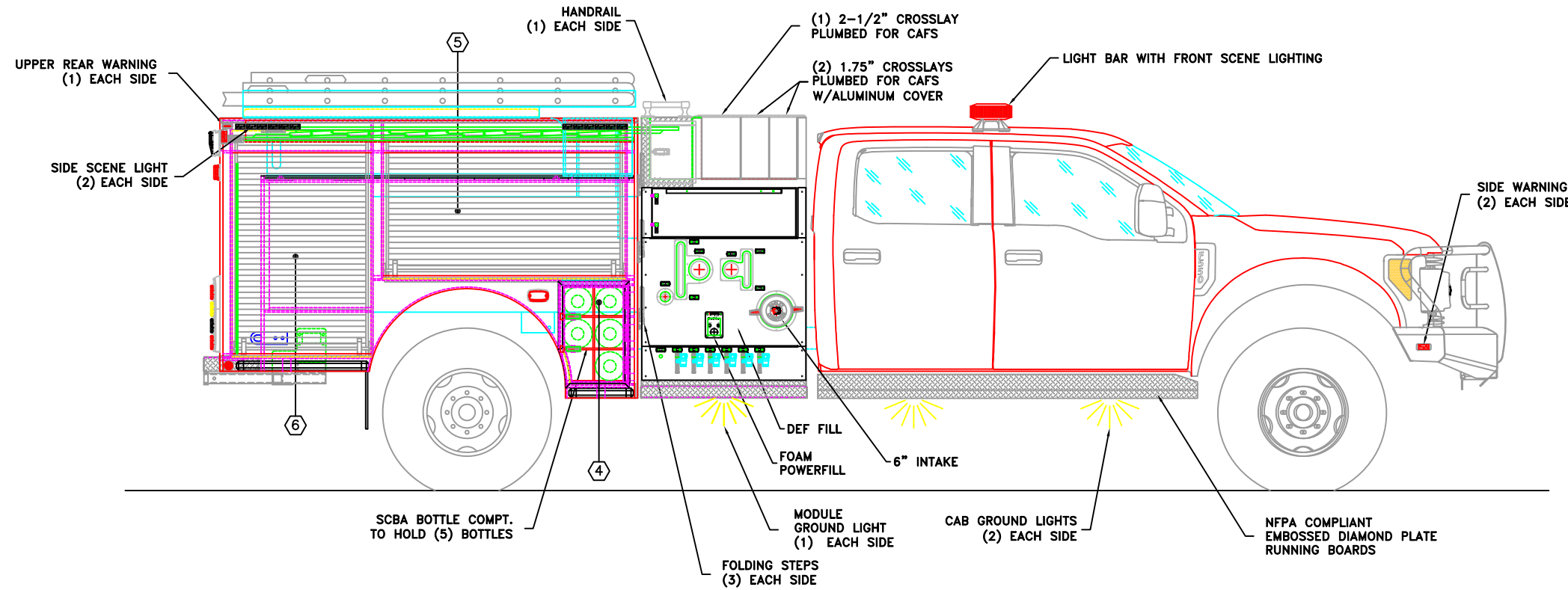

CHASSIS

MODEL	FORD	
F-550	FRNT AXLE 7,500	REAR AXLE 14,706
4 X 4	C/A 84.00	WB 203.50
	ENG. TYPE 6.7L POWERSTROKE DIESEL	

PUMP TYPE PSMC 1500 GPM SINGLE STAGE
TANK SIZE/TYPE 300 GAL WATER 25 GAL FOAM / POLY

COMPARTMENTS

MARK	SIZE	DOOR SIZE
4	15.25W X 23.88H X 20.50D	PAN DOOR
5	58.75W X 36.00H X 20.50D	58.75W X 34.00H
6	33.75W X 55.00H X 20.50D	33.75W X 53.00H
7	42.00W X 28.63H X 24.75D	42.00W X 26.63H

DRAWING NOTES

DIMENSIONS SHOWN ARE APPROXIMATE AND ARE SUBJECT TO MINOR DEVIATIONS DURING CONSTRUCTION NOT ALL ITEMS SPECIFIED ARE ON THIS PRINT

BODY CONSTRUCTION -
REAR DOORS -
SIDE DOORS -
DOOR HANDLES -
DOOR STAYS VERTICAL -
DOOR STAYS HORIZONTAL -
COMPARTMENT INTERIORS -
PUMP PANEL FINISH -
OPERATORS PANEL -
LIGHT BAR TYPE -
LIGHT BAR LOCATION -
REAR BEACONS -
SPOT LIGHTS REAR -
SPOT LIGHTS FRONT -
SCENE LIGHTS TYPE -
SCENE LIGHT LOCATIONS -

UNDER BODY LIGHTS -
REAR SIDE LIGHTS -
INTERSECTION LIGHTS -
AIR HORNS -
SIREN/SPEAKER TYPE -
SIREN/SPEAKER LOCATION -
GENERATOR TYPE -
GENERATOR LOCATION -

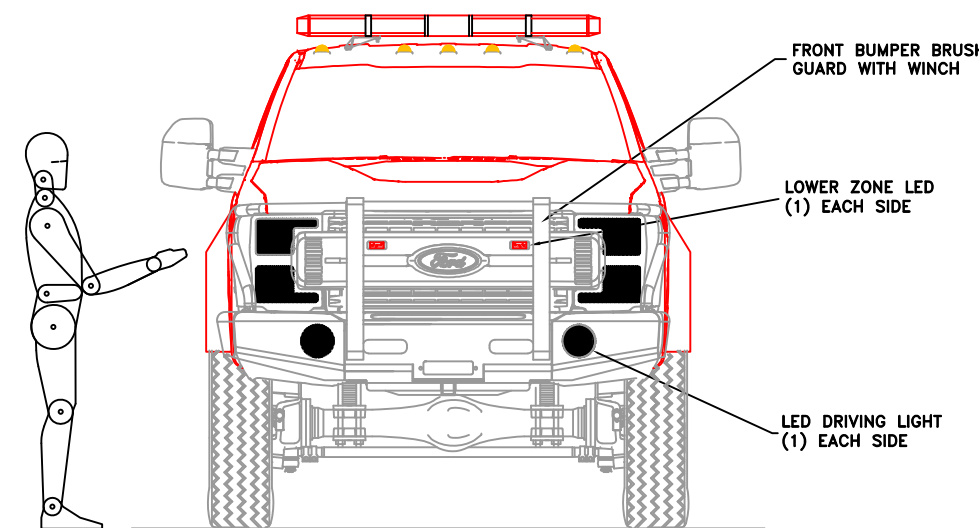
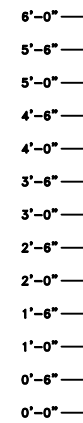
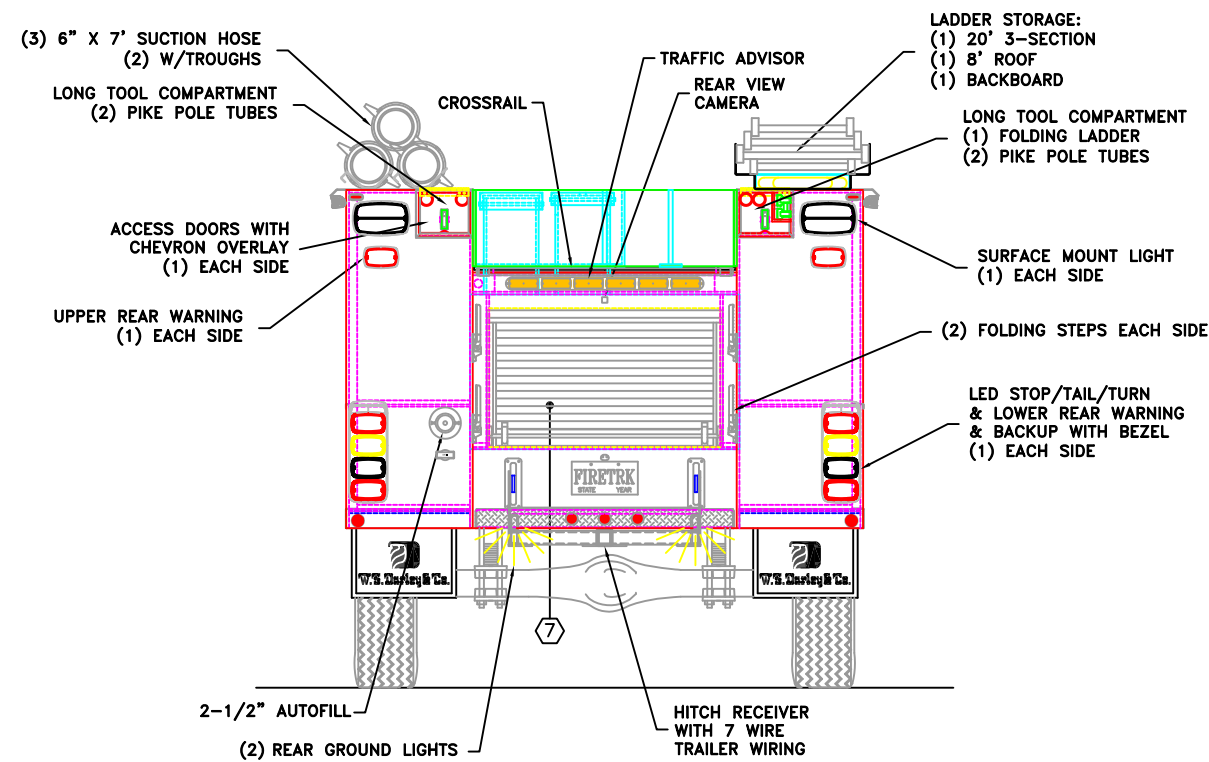

CUSTOMER APPROVAL SIGNATURE	DATE	REVISIONS
SCALE 3/4" = 1'-0"		DATE FEBRUARY 26, 2024
QW BASE SPEC		DRY K. HALOPKA
THIS DESIGN IS THE PROPERTY OF W.S. DARLEY AND CO. - UNAUTHORIZED REPRODUCTION IS PROHIBITED.		ALL DIMENSIONS IN INCHES UNLESS NOTED
DO NOT SCALE PRINT		JOB NO. MAX F550
DWG FILE NAME 13001004		SHEET NO. 2

PROJECT
MAX F550 TACTICAL PUMPER™
for
W.S. DARLEY
CHIPPEWA FALLS, WI

W.S. Darley & Co.
APPARATUS DIVISION
920 KURTH ROAD
CHIPPEWA FALLS, WI 54729
1-715-726-2645