

REVISIONS				
LTR	DESCRIPTION	DATE	CHG NO.	APPRD
A	AZ01709 WAS AZ01706	01/26/12	8053	RJG

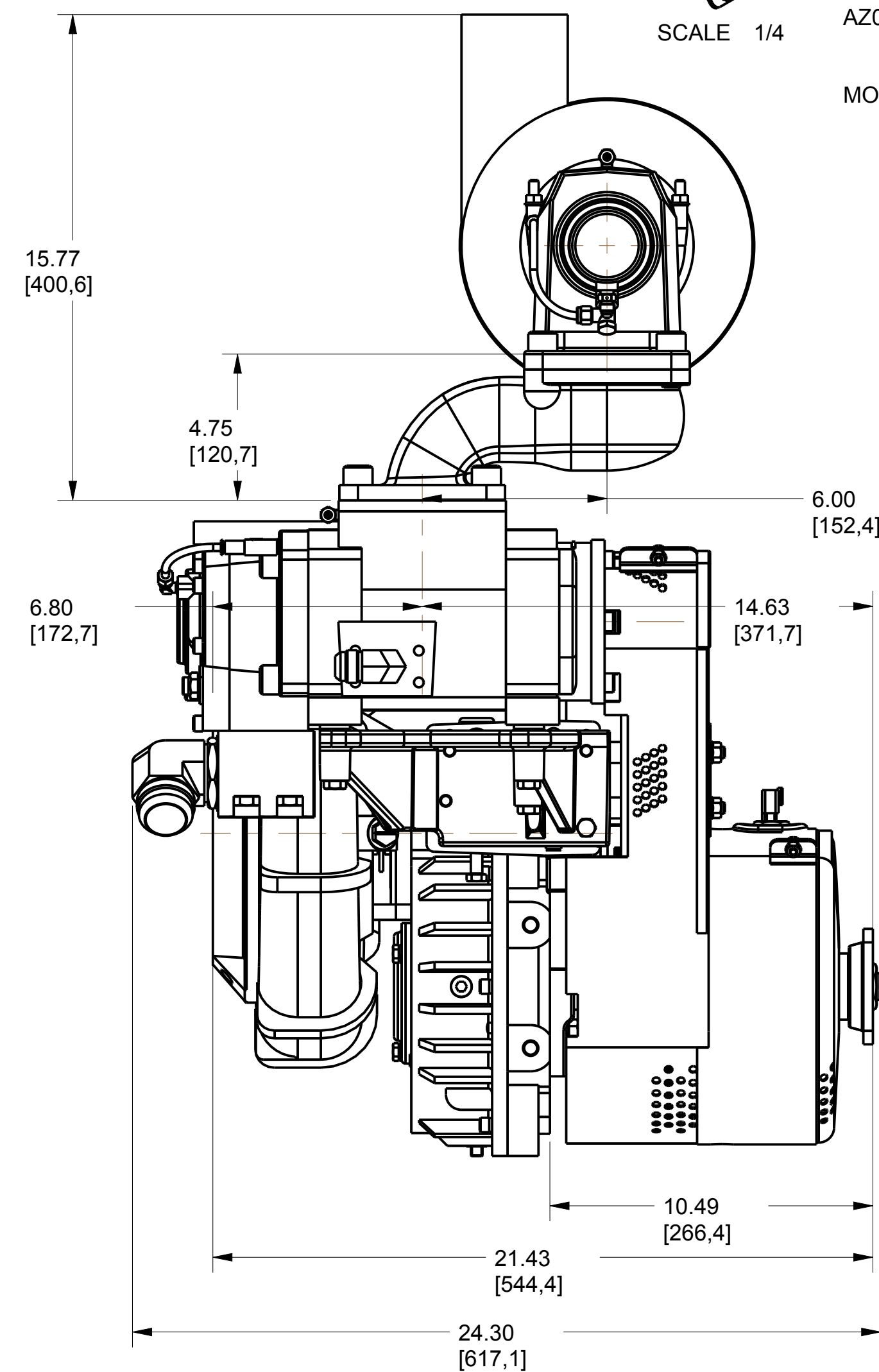

AZ00806 - OFFSET AIR INLET VALVE ASSEMBLY - NOTE THAT A REMOTE MOUNT AIR CLEANER ASSEMBLY MAY BE USED, AND THE OFFSET ELBOW ELIMINATED

225 CFM ENDURO 12 TS COMPRESSOR ASSY - AZ00407

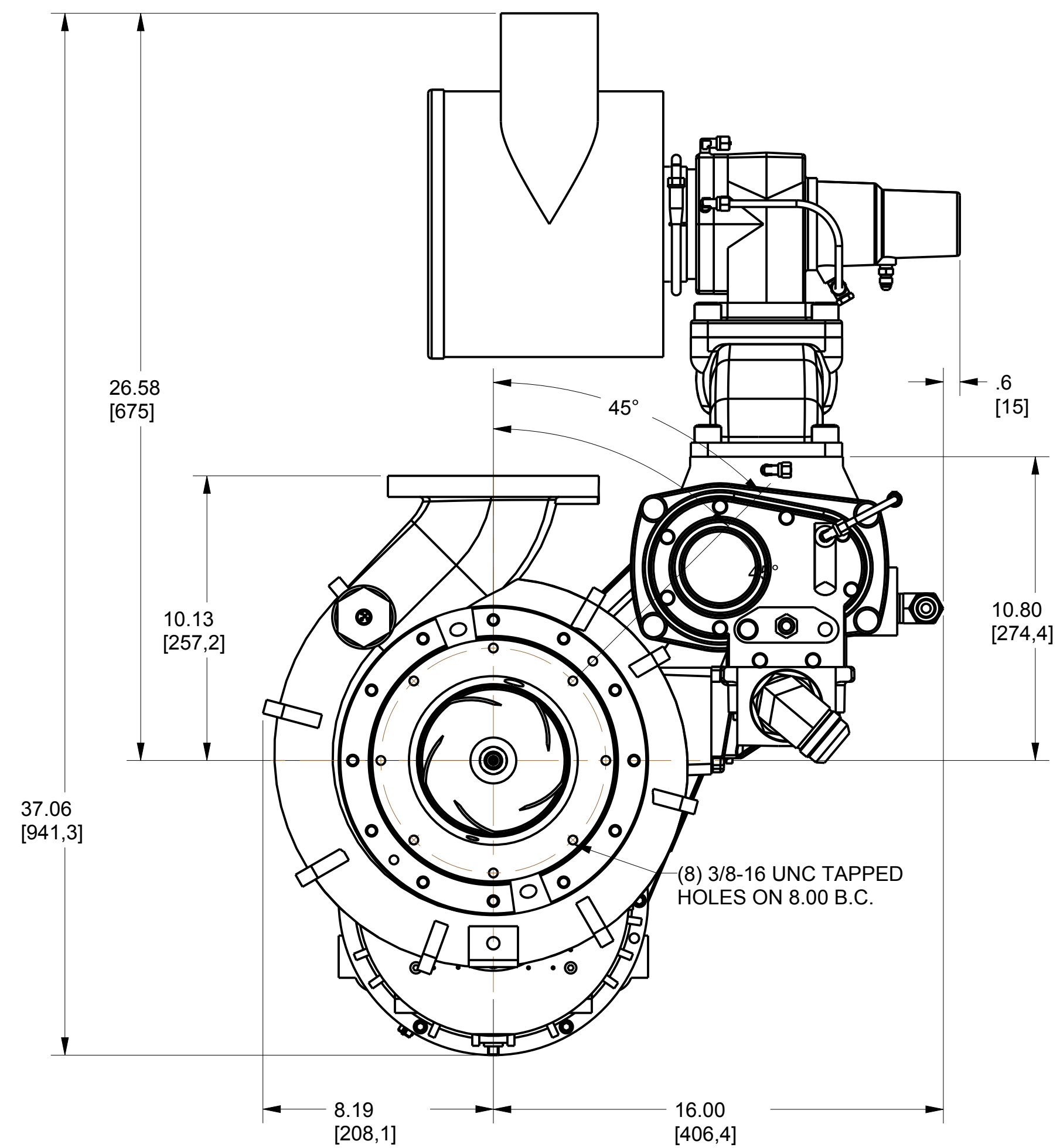
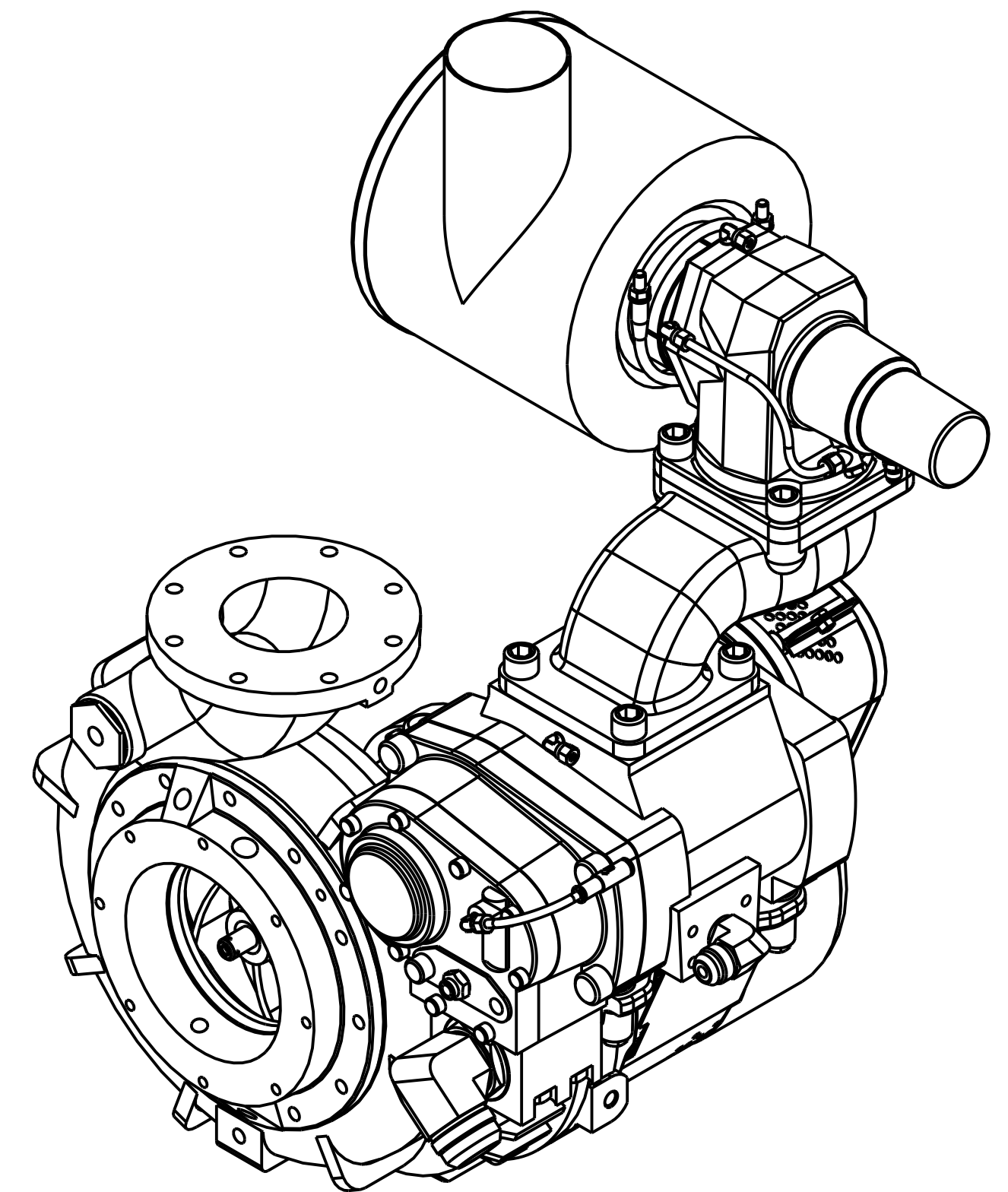
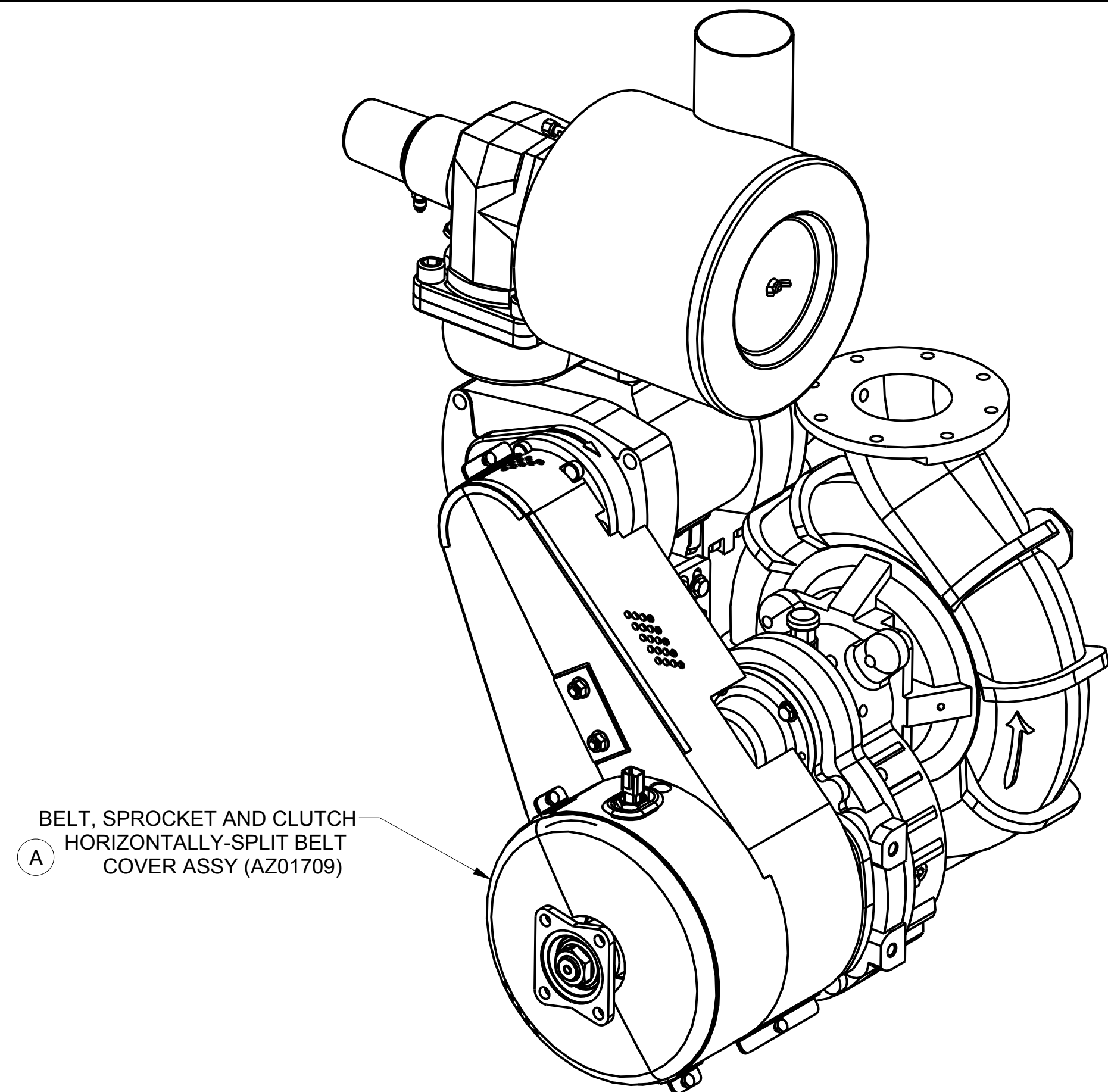
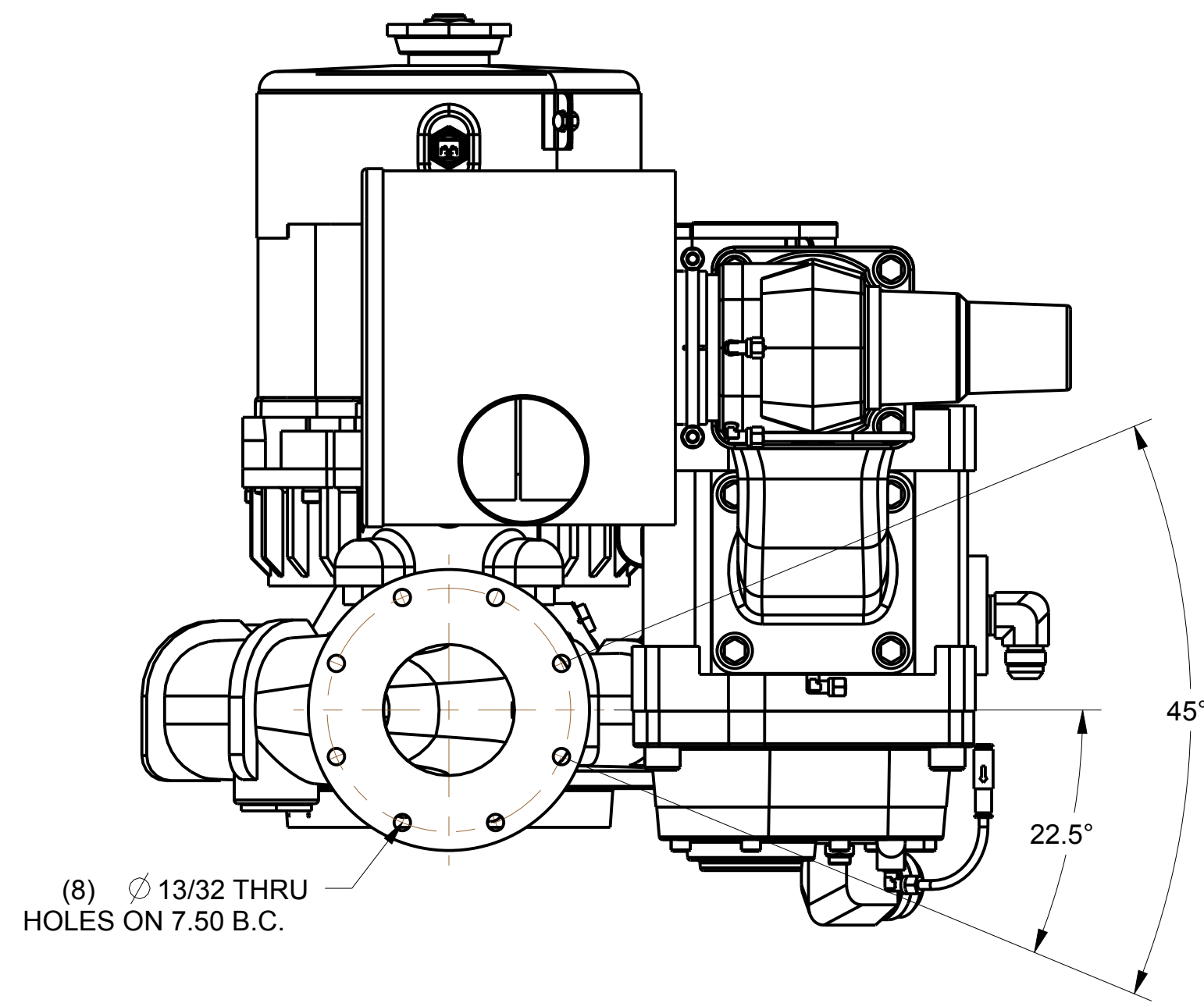
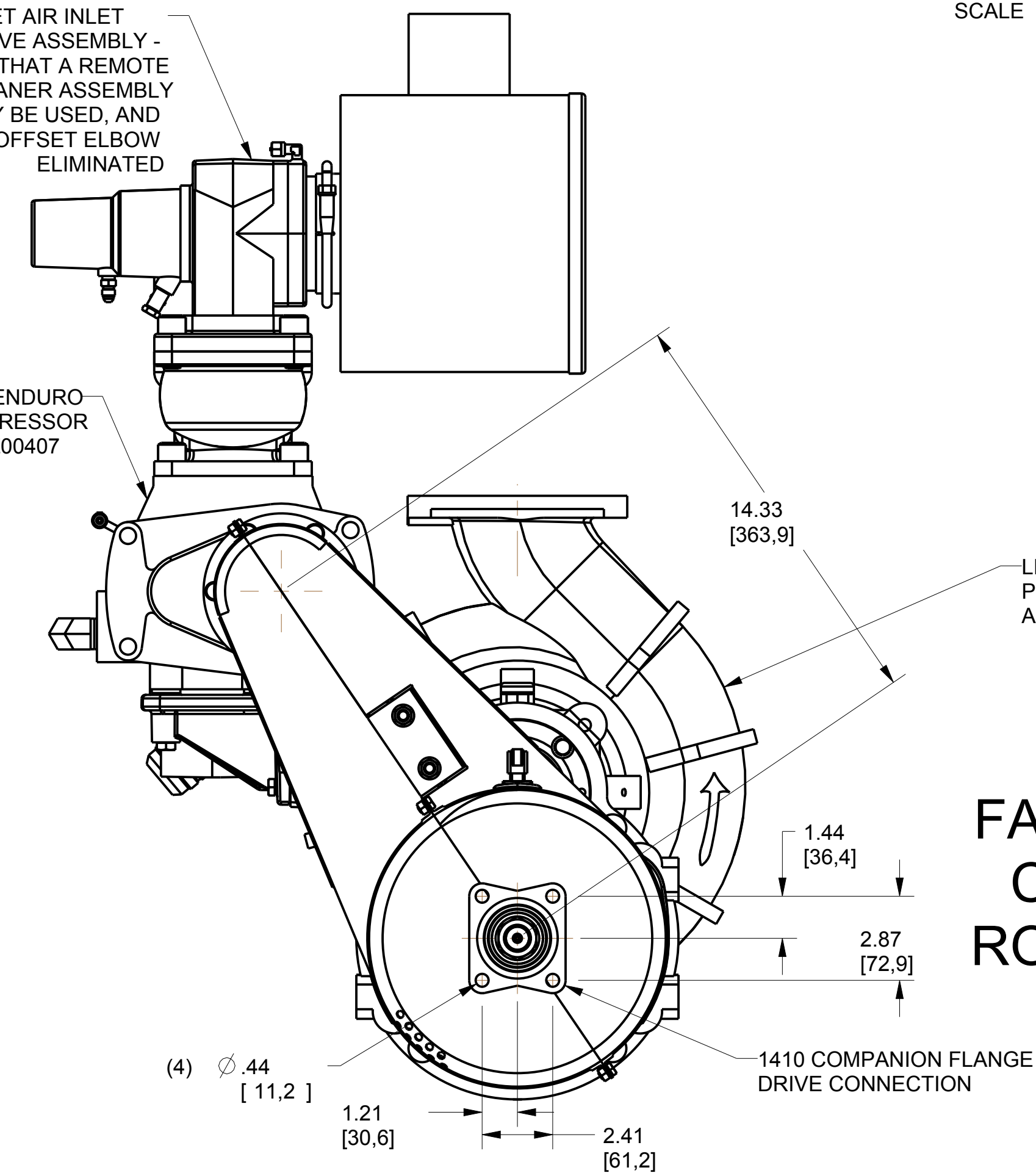

LEFT HAND PUMP CASING AND IMPELLER

**FACING INPUT SHAFT  
CLOCKWISE INPUT  
ROTATION REQUIRED**

REMOVE SHARP EDGES		INCH (MILLIMETER)		TOLERANCE EXCEPT AS NOTED 00 ±.03 2000 ±.010 ANGLES ±1°		OLD PART NO.		DATE 23-Nov-10		SCALE 1/4	
MATERIAL DESCRIPTION:		MATERIAL NO.		PATTERN NO.		DWG - KSPBC, 2GR, PTO, LOCK-ON, BELT DR. COMP DIMENSIONAL		DATE 23-Nov-10		SCALE 1/4	
THIS DESIGN IS THE PROPERTY OF W.S. DARLEY AND CO. - UNAUTHORIZED REPRODUCTION IS PROHIBITED		ALL DIMENSIONS IN INCHES UNLESS NOTED		DO NOT SCALE PRINT		DRY R/JG CHKD MCR TRCD		DATE 23-Nov-10		SCALE 1/4	

MODEL NAME DKD0414 MDL CREATED 09/10/10 SHEET 1/1 D

W.S. Darley & Co.  
ITASCA, IL - CHIPPEWA FALLS, WI

DKD0414