

W.S. Darley & Co.

TRUSTED WORLDWIDE SINCE 1908



Pump Plant & Engineering

1051 Palmer Street
Chippewa Falls, WI 54729
Phone 800-634-7812

Pump Sales & Corporate

325 Spring Lake Dr.
Itasca, IL 60143-2072
Phone (708) 345-8050
Fax (708) 345-8993

Date: _____

Bill To: _____

P.O. No.: _____

Customer No.: _____

Order Completed By: _____

Desired Delivery Date: _____

End Customer: _____

Customer Contact:

Tel No.: _____

Fax No.: _____

Email: _____

Ship To: _____

PUMP ORDER FORM

Diesel E Gov Portable Pump

Please review the order form before starting. If any challenges arise, please call our Customer Service Department at 1-800-634-7812 for assistance. We will be glad to help. Please fill in the information completely.

Engine Type:

24 HP Kubota

Single Panel

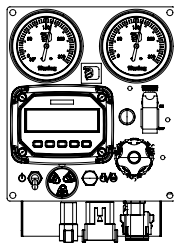

0-300 Gauge - AC002420

0-600 Gauge - AC002421

300 PSI Gauge Not
Recommended For High
Pressure Applications

Dual Panel

(Includes Single and Remote Panel)s

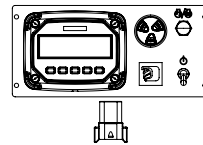
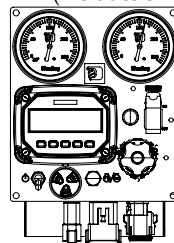

0-300 Gauge 20' Harness - AC002424

0-300 Gauge 30' Harness - AC002425

0-600 Gauge 20' Harness - AC002426

0-600 Gauge 30' Harness - AC002427

Optional Engine Accessories:

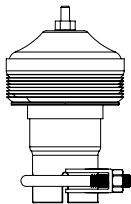

Spark Arrester KE00511

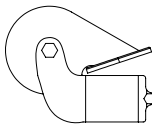

Rain Cap - 4200703

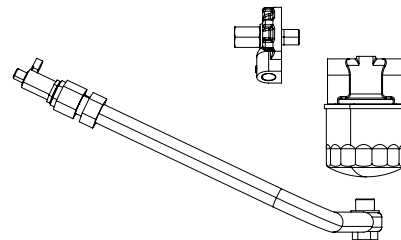

Remote Oil Filter and Drain - 4209818

Pump Model:

1.5 AGE

(Page 3)

2.5 AGE

(Page 4)

2BE

(Page 5)

1.5 AGE Pump Options:

Required Standard Assemblies:

1978321 - EPA P65 Tag
TE00435 - Transmission Assembly

Discharge Position

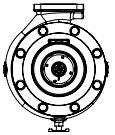

Standard

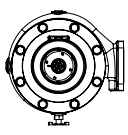

90 Degrees

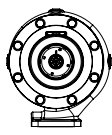

180 Degrees

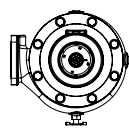

270 Degrees

Gearcase Position

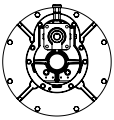

Standard

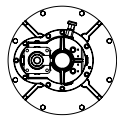

Input Right

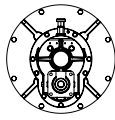

Inverted

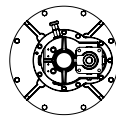

Input Left

Inlet Option

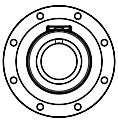

2800333 - 2.5" NPT

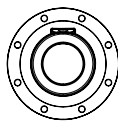

2800331 - 2.0" NPT

Pump Ratings - Gear Ratios

PA00270 - HIGH PRESSURE MECH SEAL

KR00106 - 3.00:1 GEAR RATIO
25 GPM @ 360 PSI
75 GPM @ 250 PSI
120 GPM @ 170 PSI

KR00107 - 3.17:1 GEAR RATIO
25 GPM @ 375 PSI
75 GPM @ 230 PSI
120 GPM @ 130 PSI
120 GPM @ 150 PSI

PA00272 - HIGH VOLUME MECH SEAL

KR00102 - 2.33:1 GEAR RATIO
80 GPM @ 210 PSI
150 GPM @ 130 PSI
180 GPM @ 100 PSI

KR00104 - 2.70:1 GEAR RATIO
60 GPM @ 245 PSI
140 GPM @ 145 PSI
180 GPM @ 80 PSI

KR00106 - 3.00:1 GEAR RATIO
25 GPM @ 300 PSI
75 GPM @ 200 PSI
100 GPM @ 170 PSI

DISCHARGE OPTIONS

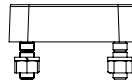

YF00035 - 2" NPT

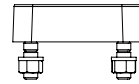

YF00032 - 1.5" NPT

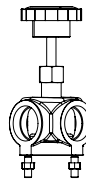

HA00104 - (2) 1.5" NPT

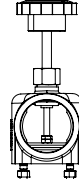

HA00206 - (1) 2.5" NPT

2.5 AGE Pump Options:

Required Standard Assemblies:

1978321 - EPA P65 Tag
 PA00633 - Pump Assembly
 TR00435 - Transmission Assembly
 KR00114 - 1.94:1 Gear Ratio

Discharge Position

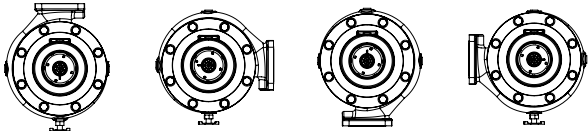

Standard 90 Degrees 180 Degrees 270 Degrees



Discharge Options



YF02931 - 2.0" NPT YF02930 - 2.5" NPT YF02932 - 3.0" NPT

Gearcase Position

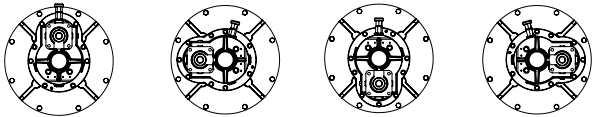

Standard Input Right Inverted Input Left

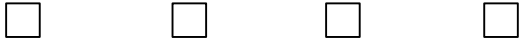

YF02933 - 2.5" BSP YF02937 - 2.5" Weld

Inlet Options

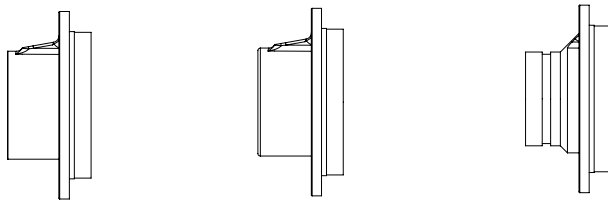

2800803 - 2.5" NPT 2800804 - 2.5" BSP 2800805 - 3.0" Victaulic

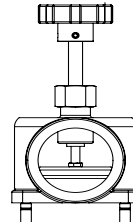

HA00317
 (1) 2.5" NPT

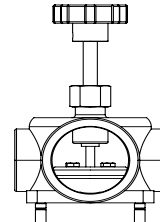

HA00313
 (2) 1.5" NPT
 (2) 2.5" NPT

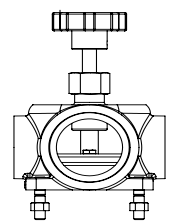

HA00308
 (1) 2.5" NPT
 (2) 1.5" NPT

2BE Pump Options:

Required Standard Assemblies:

1978321 - EPA P65 Tag
1963108 - Serial Plate 2BE

Discharge Position Options

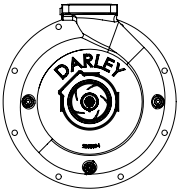

Standard

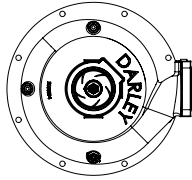

90 Degrees

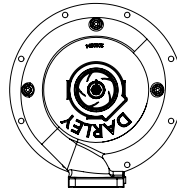

180 Degrees

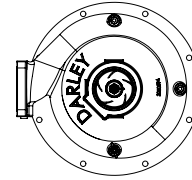

270 Degrees



Adapter Options



1602200

1.5" NPTM X 1.5NHM

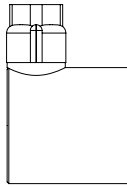

1600705

2.5" NHF X 2.5" INST

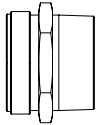

1602400

2.5" NPTM X 2.5" NHM

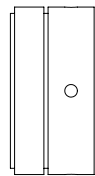

KC01505

3.0" NHM X 3.0" NPTM

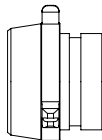

1644510

3.0" NPTM X 2.5" Vitaulic

Discharge Options

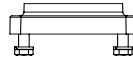

YF02931 - 2.0" NPT

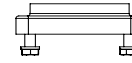

YF02930 - 2.5" NPT

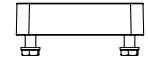

YF02932 - 3.0" NPT

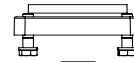

YF02933 - 2.5" BSP

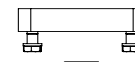

YF02937 - 2.5" Weld

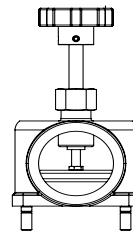

HA00317

(1) 2.5" NPT

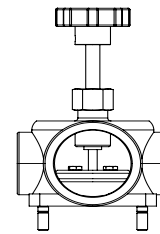

HA00313

(2) 1.5" NPT
(2) 2.5" NPT

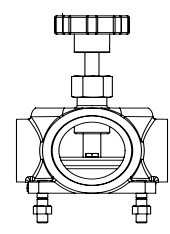

HA00308

(1) 2.5" NPT
(2) 1.5" NPT