

REVISIONS				
LTR	DESCRIPTION	DATE	CHG NO.	APPRD
-	-	-	-	-

OPTIONAL PUMP CASING POSITIONS
DISCHARGE CENTERED TO SUCTION

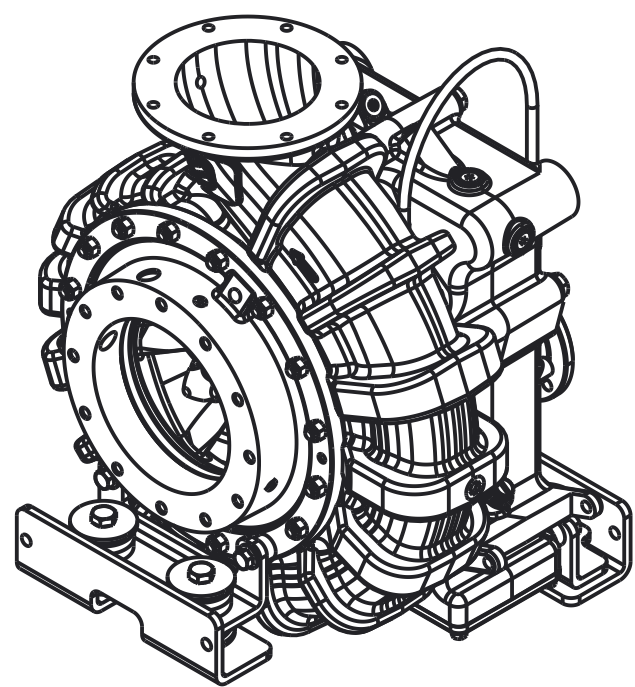

SCALE 1/8

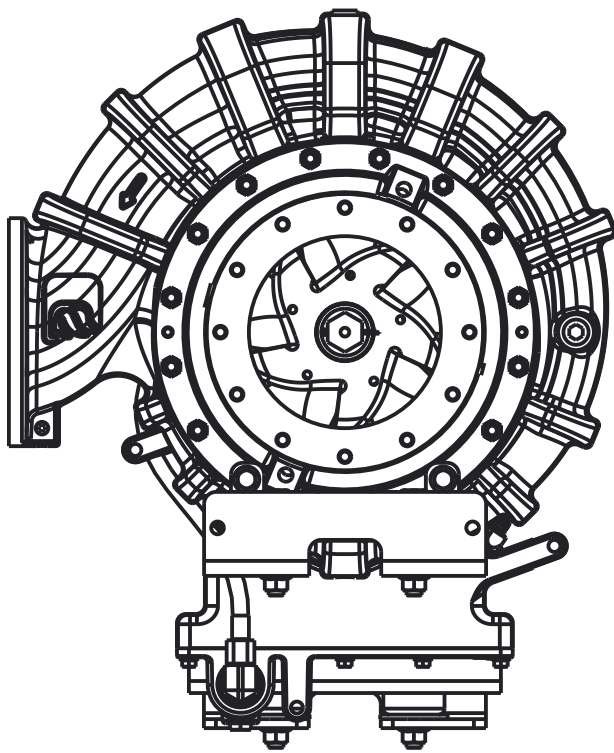

9 O'CLOCK DISCHARGE

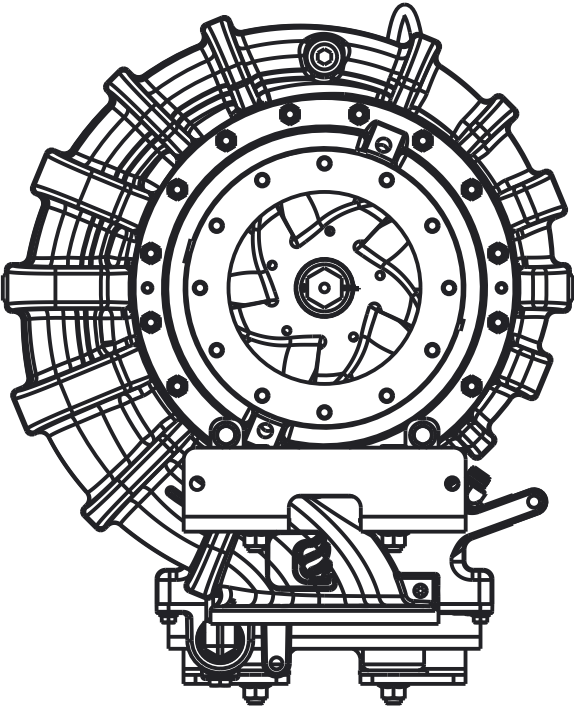

6 O'CLOCK DISCHARGE

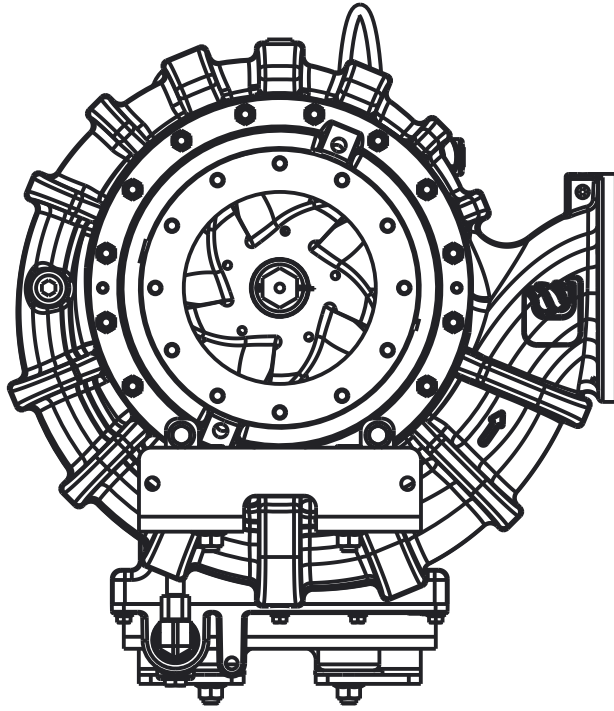

3 O'CLOCK DISCHARGE

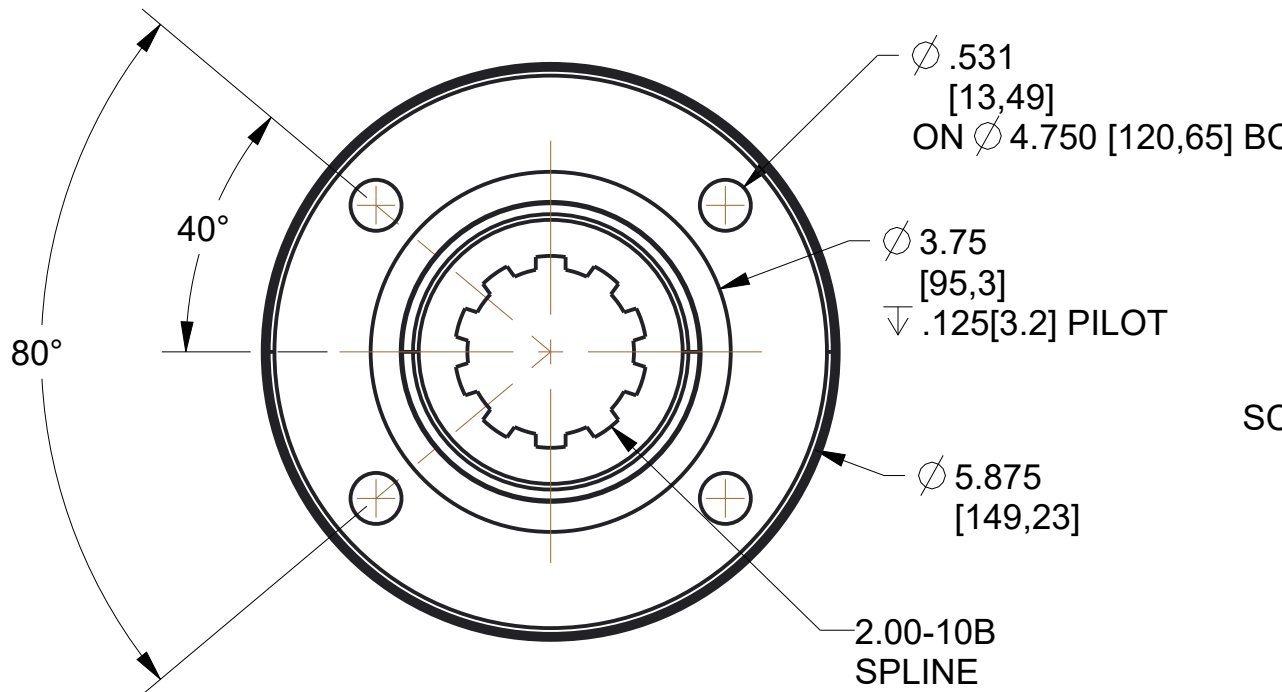

1550 COMPANION FLANGE

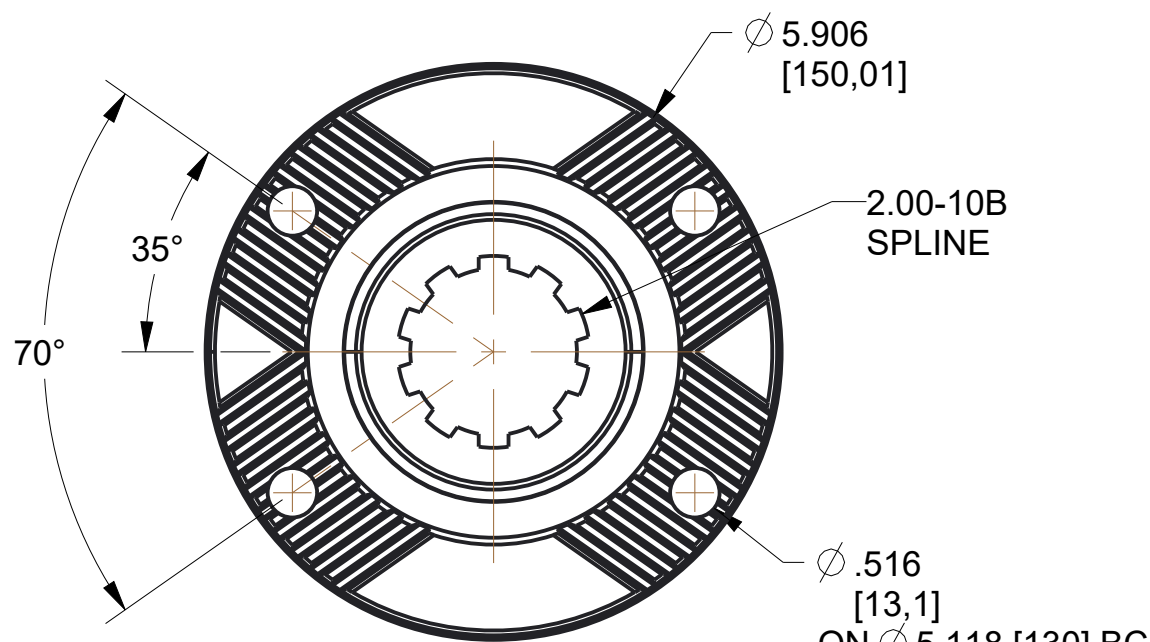

ISO 8667-T150 TOOTHED FLANGE

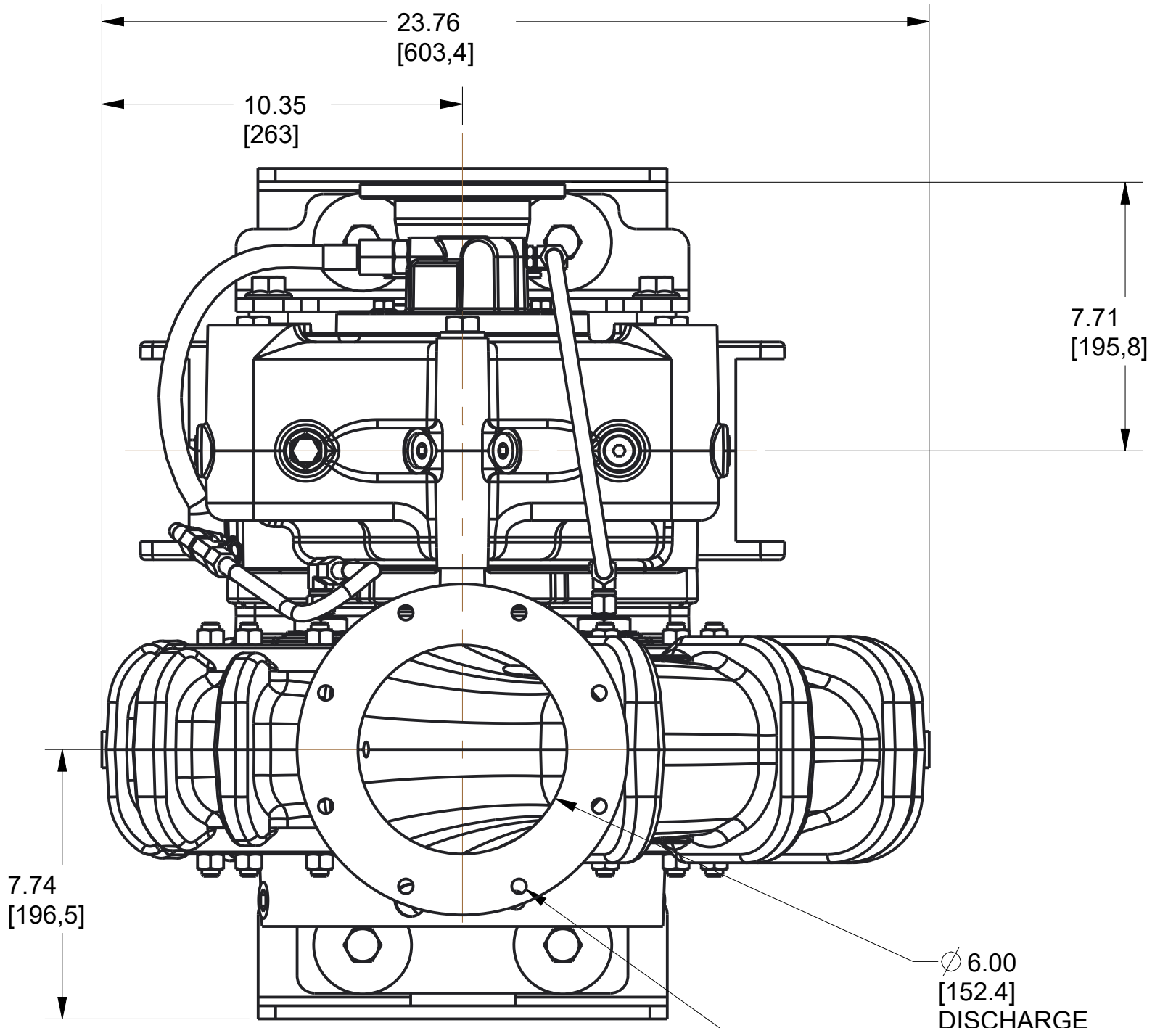

Ø 6.00 [152,4] DISCHARGE
(8) 1/2-13 UNC-2B TAP
▽ .75 THR'D ON Ø 8.500 BC

1550 COMPANION FLANGE
OR
ISO 8667-T150 TOOTHED FLANGE

TRANSMISSION OIL
LEVEL DIPSTICK
STANDARD SCREWDRIVER
TO REMOVE

7.59
[192,8]

10.63
[270]
11.75
[298,5]

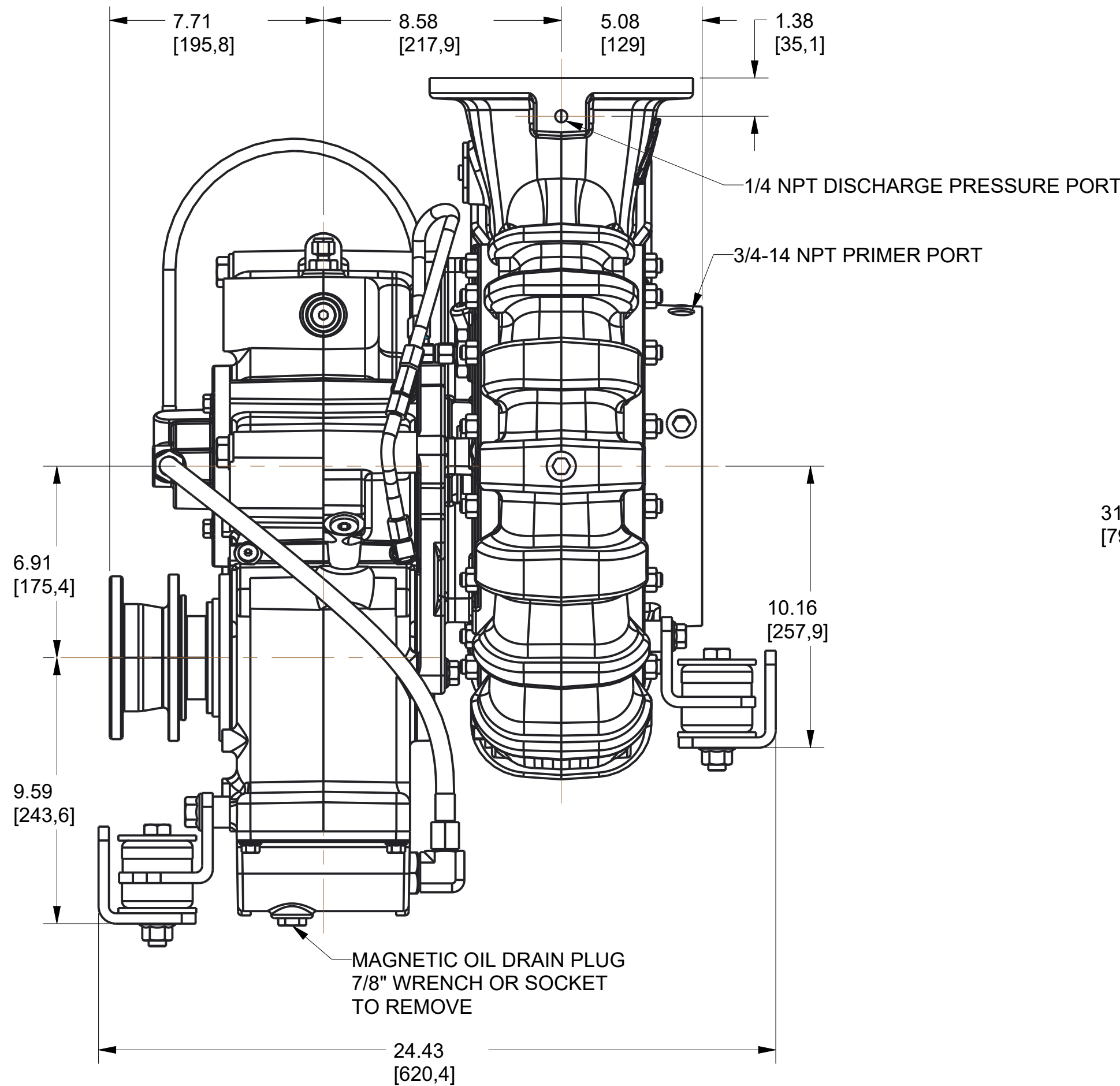

MAGNETIC OIL DRAIN PLUG
7/8" WRENCH OR SOCKET
TO REMOVE

1/4-18 NPT SCREENED
DISCHARGE PORT

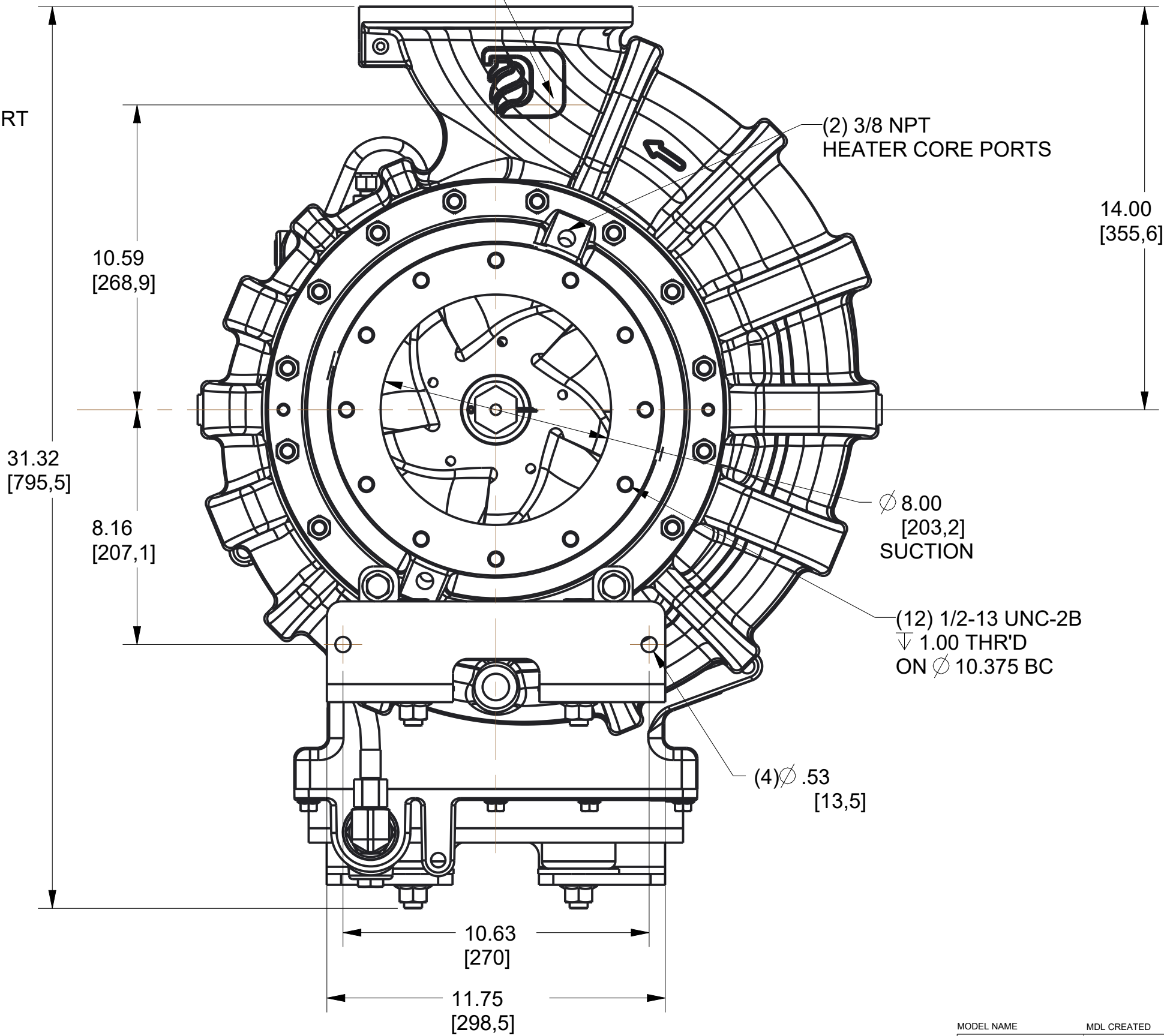

(2) 3/8 NPT
HEATER CORE PORTS

Ø 8.00 [203,2]
SUCTION

(12) 1/2-13 UNC-2B
▽ 1.00 THR'D
ON Ø 10.375 BC

(4) Ø .53
[13,5]

REFERENCE NOTES:
APPROXIMATE WEIGHT = 662 LB (300 KG)
PUMP SHOWN IS COMPRISED OF THE FOLLOWING ASSEMBLIES:
TRANSMISSION - TP01921
PUMP - PZ00001 (FRESH WATER)
IMPELLER - 2908700 (OPPOSITE ENGINE ROTATION DRIVE SOURCE - OPP ER)
TRANSMISSION MOUNTING KIT - KM02103
SUCTION HEAD MOUNTING KIT - KM02102
GEAR RATIO - KR07306 (1.76:1) - EXTERIOR DIMENSIONS ARE THE SAME REGARDLESS OF THE GEAR RATIO USED
LOCK-ON INPUT YOKE - 4822512 (1550) OR 4822711 (T150)

REMOVE SHARP EDGES

INCH
[MILLIMETER]



OLD PART NO.

TOLERANCE
EXCEPT
AS NOTED

W.S. Darley & Co.
ITASCA, IL - CHIPPEWA FALLS, WI

MATERIAL DESCRIPTION:

AS LISTED

MATERIAL NO.

PATTERN NO.

DATE 04MAR2021

SCALE 1/4

THIS DESIGN IS THE PROPERTY OF
W.S. DARLEY AND CO. - UNAUTHORIZED
REPRODUCTION IS PROHIBITED.

ALL DIMENSIONS IN
INCHES UNLESS NOTED

DO NOT SCALE PRINT

DRN WAH
CHKD -
TRCD

DATE 04MAR2021

DZD0071