

REVISIONS				
LTR	DESCRIPTION	DATE	CHG NO.	APPRD
A	WAS 6.79. ADDED VIEWS	22MAR2017	11610	SMS

OPTIONAL PUMP CASING POSITIONS
DISCHARGE CENTERED TO SUCTION

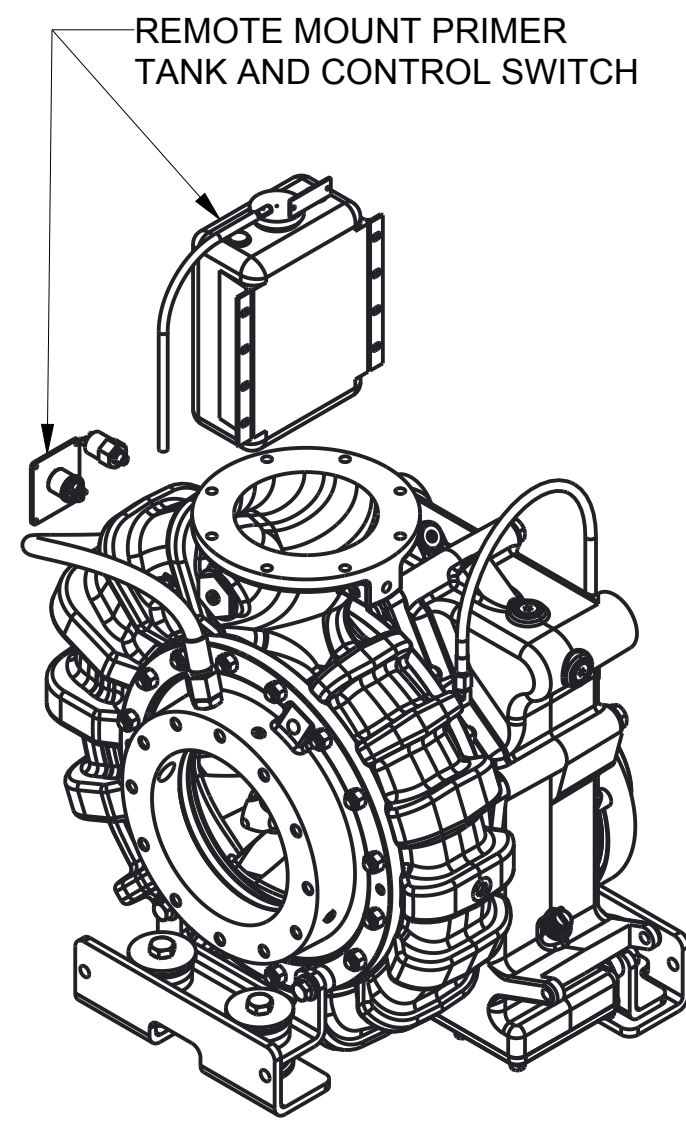

SCALE 1/8

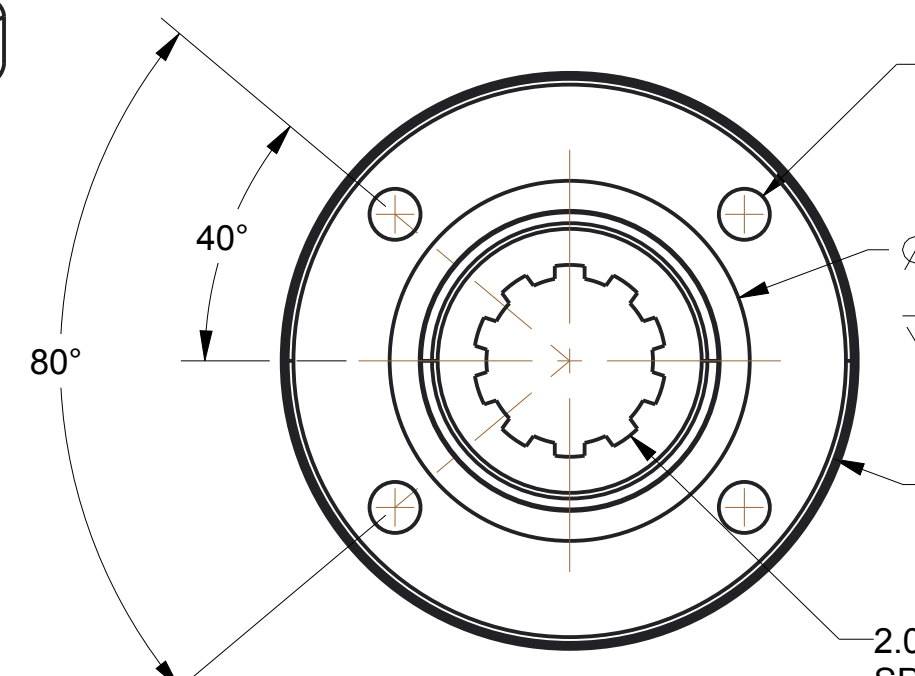
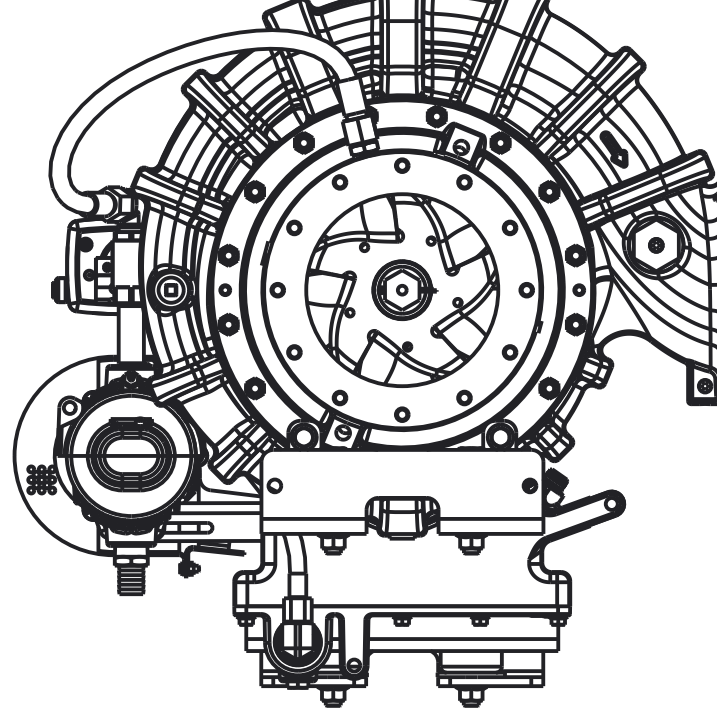
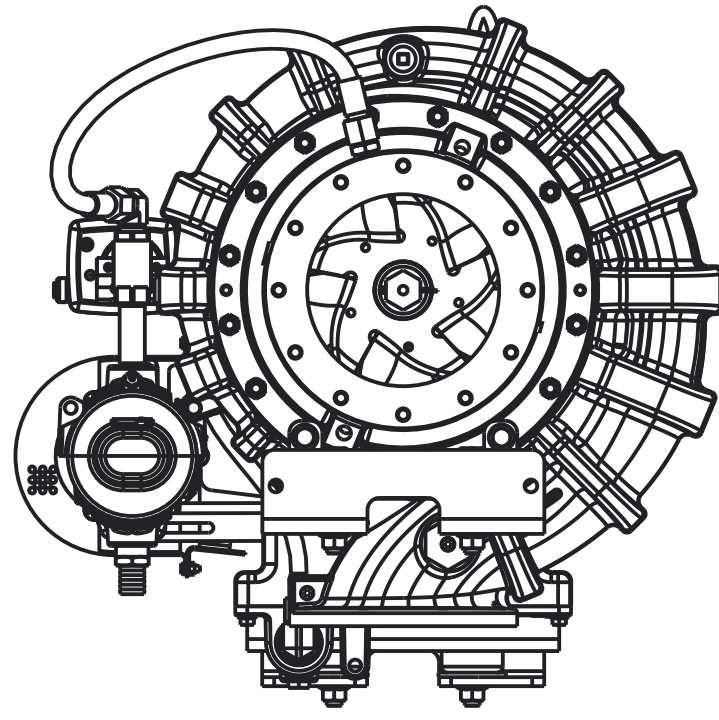
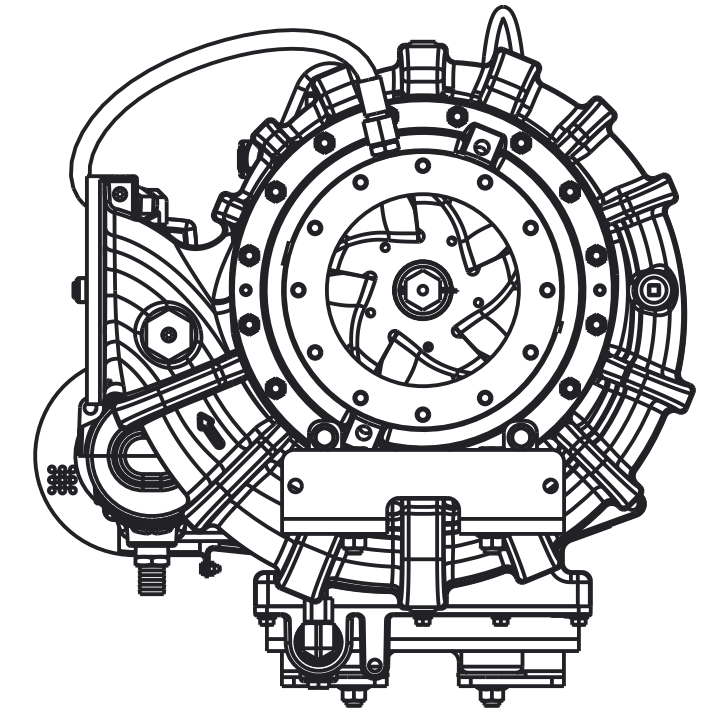

SCALE 1/2

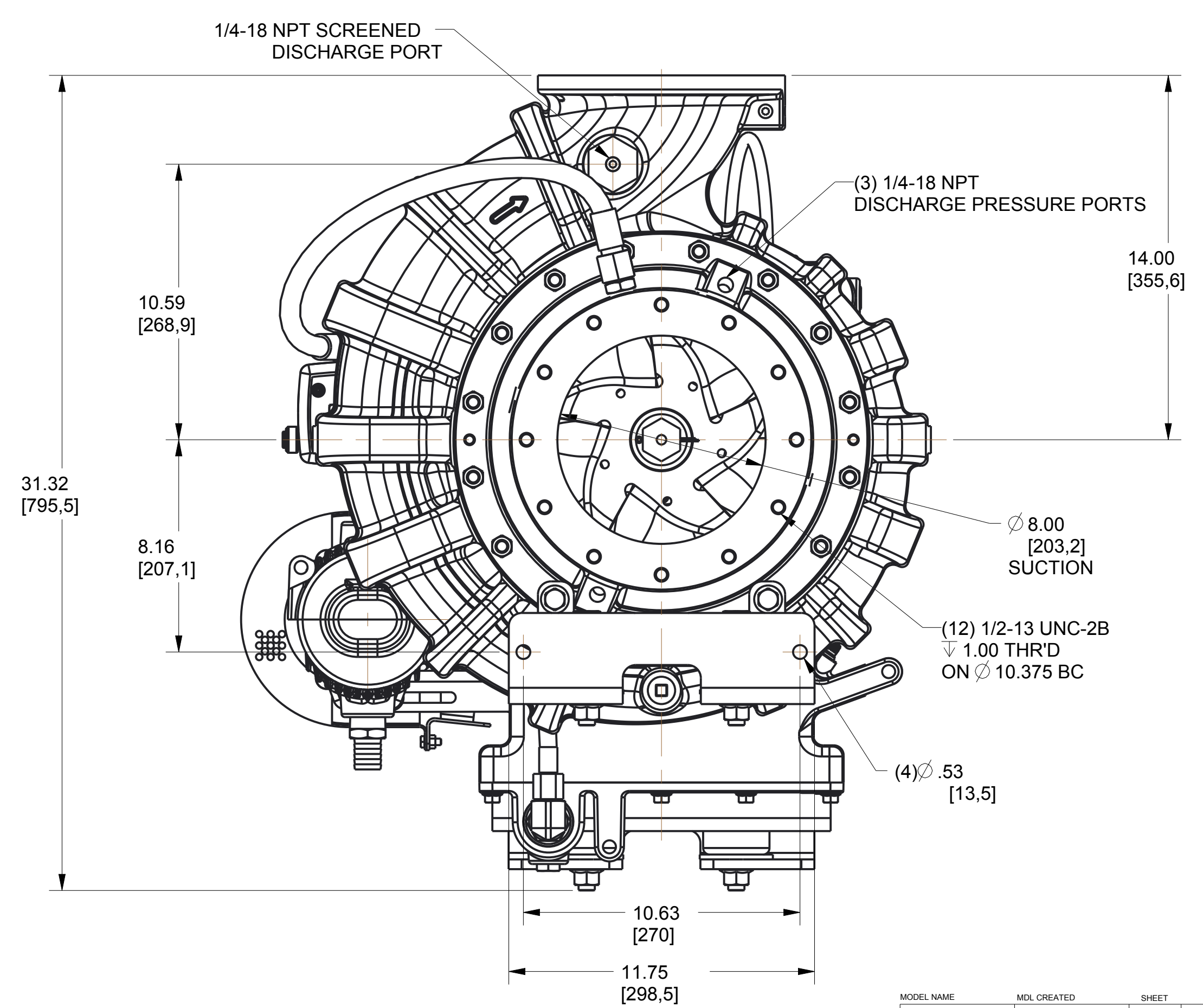
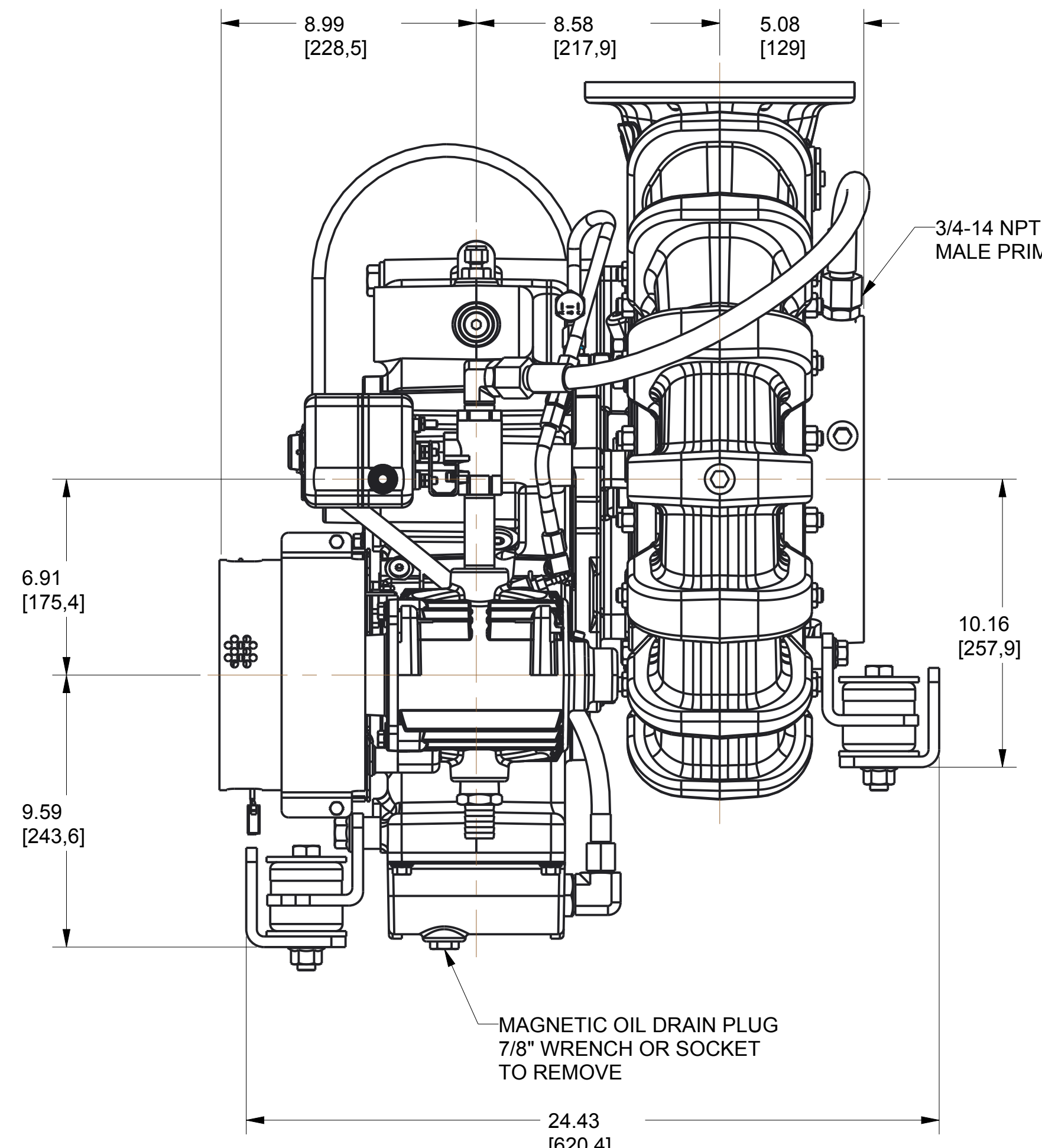
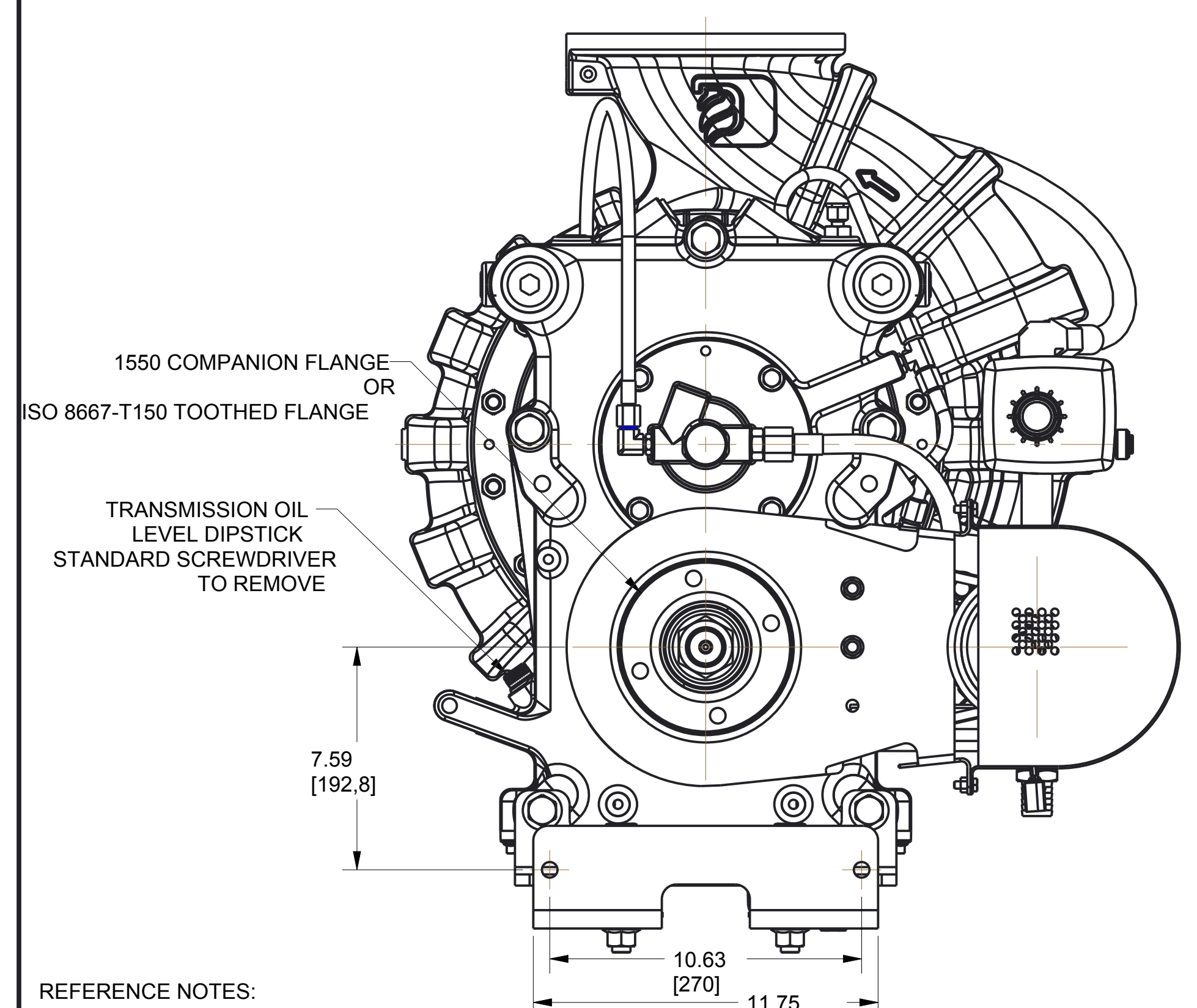
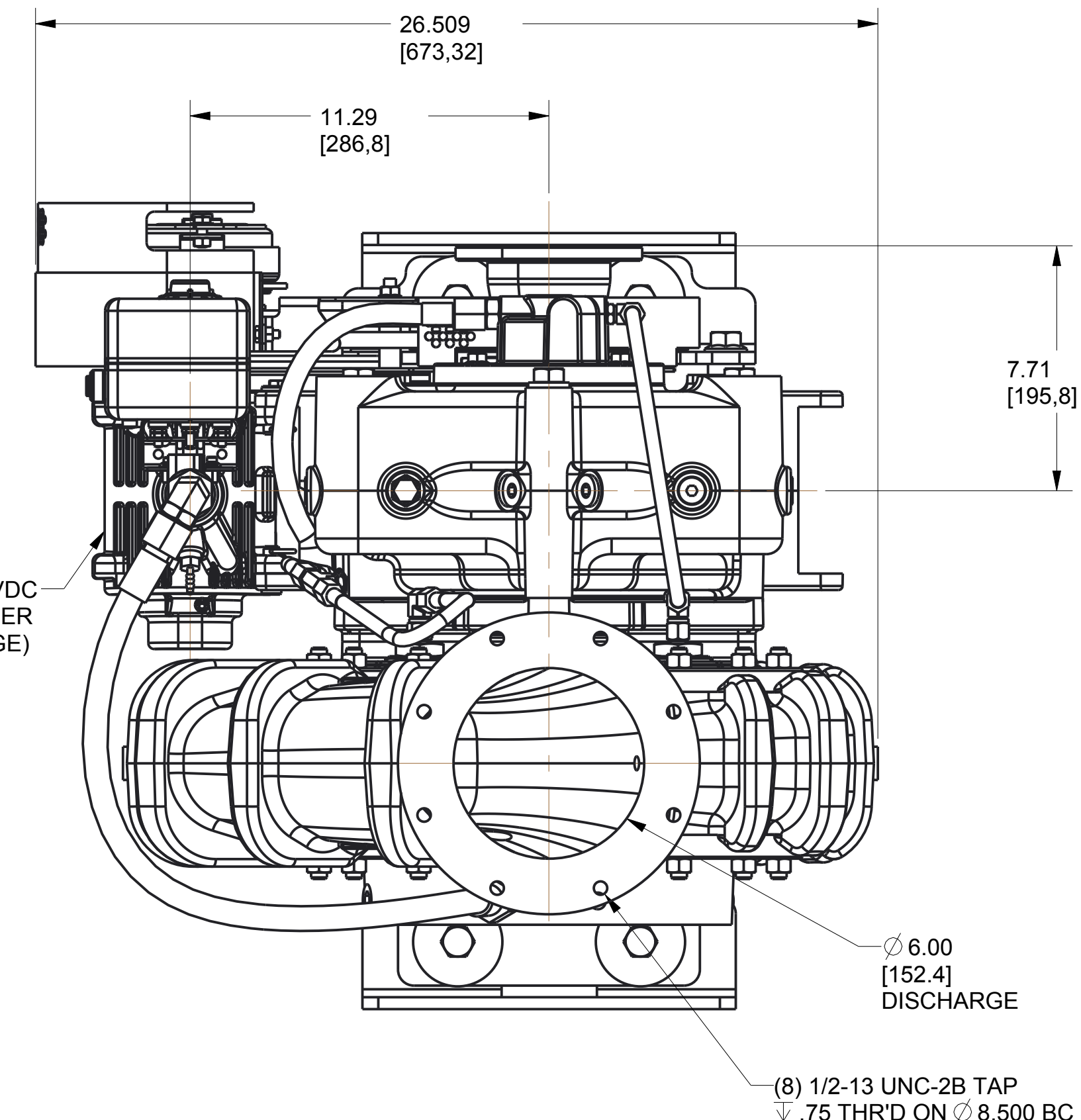
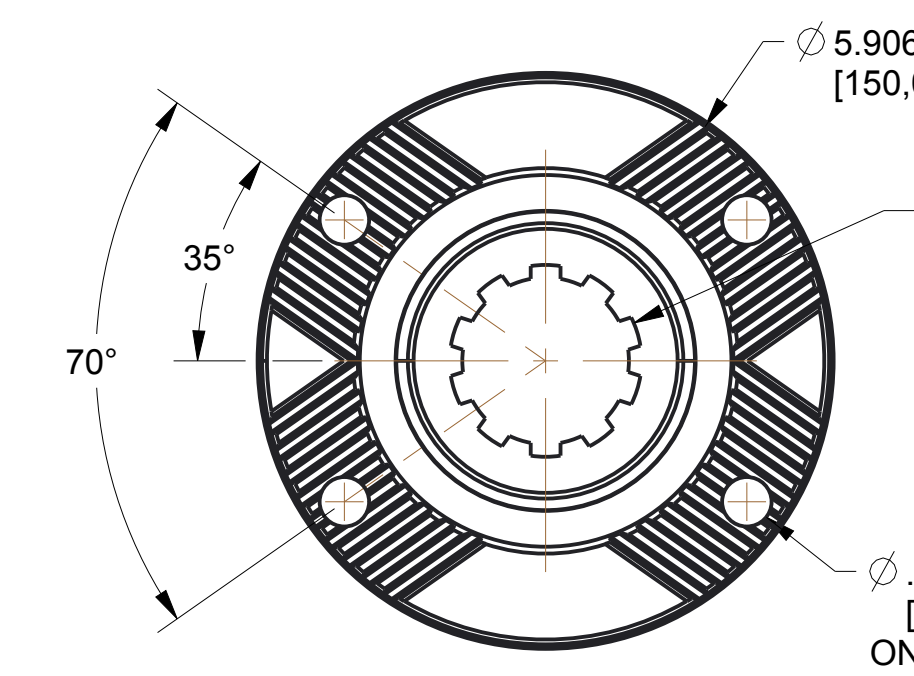

REFERENCE NOTES:
APPROXIMATE WEIGHT = 718 LB (326 KG)
PUMP SHOWN IS COMPRISED OF THE FOLLOWING ASSEMBLIES:
TRANSMISSION - TP01921
PUMP - PZ00001 (FRESH WATER)
IMPELLER - 2908600 (ENGINE ROTATION DRIVE SOURCE - ER)
TRANSMISSION MOUNTING KIT - KM02103
SUCTION HEAD MOUNTING KIT - KM02102
GEAR RATIO - KR07306 (1.76:1) - EXTERIOR DIMENSIONS ARE THE SAME REGARDLESS OF THE GEAR RATIO USED
LOCK-ON INPUT YOKE - 4822512 (1550) OR 4822711 (T150)
BELT DRIVEN PRIMER - AP02400 (24V, ER & FRESH WATER) OR AP02401 (12V, ER & FRESH WATER)

REMOVE SHARP EDGES		INCH (MILLIMETER)	OLD PART NO.	TOLERANCE EXCEPT AS NOTED	 W.S. Darley & Co. ITASCA, IL - CHIPPEWA FALLS, WI
MATERIAL DESCRIPTION:	AS LISTED			00 ±.03 2000 ±.010 ANGLES ±.1°	
THIS DESIGN IS THE PROPERTY OF W.S. DARLEY AND CO. - UNAUTHORIZED REPRODUCTION IS PROHIBITED		ALL DIMENSIONS IN INCHES UNLESS NOTED	DO NOT SCALE PRINT	DRN WAH CHKD WAH TRCD	DWG - ZSP, INPUT STANDARD CROSS SECTION DATE 15-Jul-14 SCALE 1/4 DZD0061

MODEL NAME: DZD0061
MFL CREATED: 10JUL2014
SHEET: 1/1