

REVISIONS				
LTR	DESCRIPTION	DATE	CHG NO.	APPRD

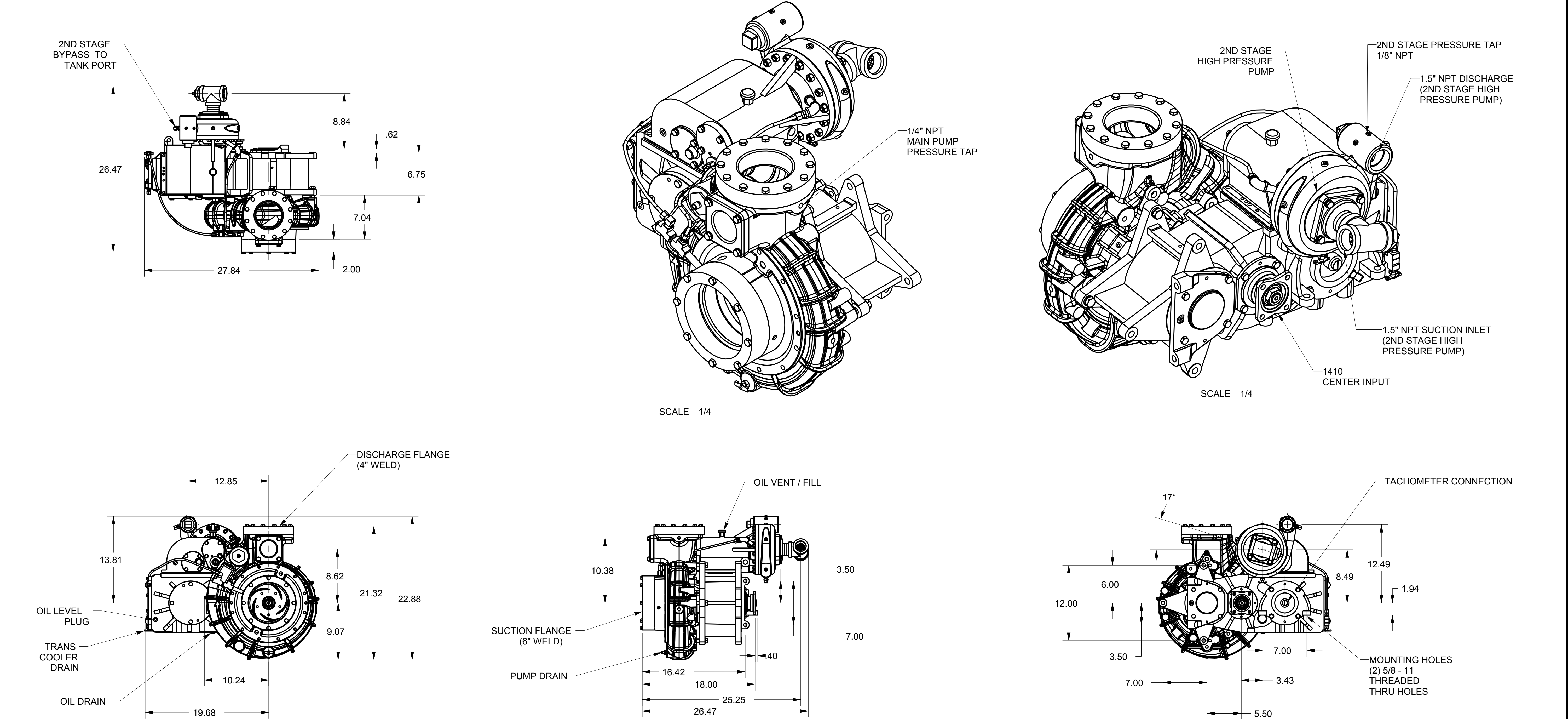

- NOTE:
- 1.) 2ND STAGE HIGH PRESSURE PUMP MUST BE CONNECTED TO THE DISCHARGE OF THE FIRST STAGE PUMP BY A HYDRAULIC HOSE FOR PUMP TO OBTAIN MAXIMUM OPERATING CONDITIONS.
 - 2.) THE APPROXIMATE WEIGHT IS 700 Lbs.

REMOVE SHARP EDGES		INCH [MILLIMETER]		TOLERANCE EXCEPT AS NOTED .00 ±.03 .000 ±.010 ANGLES ±1°		OLD PART NO.		TOLERANCE EXCEPT AS NOTED .00 ±.03 .000 ±.010 ANGLES ±1°		DWG - PSRH DIMENSIONAL	
MATERIAL DESCRIPTION: AS LISTED		MATERIAL NO.		PATTERN NO.		DO NOT SCALE PRINT		DATE 28-May-13		DPD0804	
THIS DESIGN IS THE PROPERTY OF W.S. DARLEY AND CO. - UNAUTHORIZED REPRODUCTION IS PROHIBITED.		ALL DIMENSIONS IN INCHES UNLESS NOTED		DO NOT SCALE PRINT		SCALE 1/8		DATE 28-May-13		DPD0804	