

ITEM NO.	File Name	Darley Item Description (Line 1)	QTY.
1	1805820	HOUSING - PSDE	1
2	3603016	FLAT WASHERS	3
3	2056901	PUMP CASING - PS, LG/STD EYE	1
4	3603533	WASHER - LOCK, 0.500 ID, SST	3
5	5400069	HHCS - .500-13 x 2.00, GR5	3
6	1722101	BEARING - BALL, 310SF	2
7	5022803	SHAFT - PSD NO CLUTCH	1
8	3601244	O-RING - 5.37 X 5.62 X 0.12	2
9	3206002	SLINGER - OIL, PSD, 2.402 ID	1
10	3602201	KEY - WOODRUFF, 605 (#61)	1
11	3600470	RING - RETAINER, 5100-237	1
12	2305181	RING - RETAINER, BEARING	1
13	5402845	HHCS - FLANGED, .375-16 X 1.00	4
14	3603932	WASHER - BEARING BACKUP	1
15	3600571	OIL SEAL - 2.125 X 3.00 OD	1
16	4817605	YOKE - 1410, END, 1.50-10 SPL	1
17	4814501	NUT - FLANGE, 7/8-14	1
18	1080510	PLUG - PIPE, 0.375, MAG SOC HD	1
19	4401800	VENT - GEARCASE	1
20	1080541	PLUG - PIPE, 0.375, ZINC, SOCT	2
21	3600530	OIL SEAL - 1.875 ID x 2.627 OD	1
22	3203201	SLINGER - WATER, 1.661 ID	1
23	3601011	O-RING - 3.00 x 3.12 x 0.06	1
24	1840901	HOUSING - MECHANICAL SEAL, PS	1
25	5402402	FHMS - .250-20 X 0.63, SS SOCK	4
26	1845400	MECHANICAL SEAL - 1.75 WELD SPRG	1
27	3404205	SEAL RING - PS, LG EYE IMPELLER	2
28	2909600	IMPELLER - PS, R.H. 10.969 OD	1
29	3603328	WASHER - IMPELLER	1
30	5403447	NUT - CASTLE, 1-14, 303	1
31	2806606	HEAD - SUCTION, PS	1
32	1122400	SCREEN - STRAINER, 1.50"	1
33	1122300	STRAINER FITTING	1
34	3601401	O-RING - 1.47 X 1.71 X 0.09	1
35	3601228	O-RING - 10.50 X 10.75 X .14	1
36	3601220	O-RING - 11.00 x 11.25 x 0.12	1
37	1080533	PLUG - PIPE, .125, SST SOC HD	1
38	1080551	PLUG - PIPE, 0.750, SS SOC HD	3
39	1080535	PLUG - PIPE, .250, SS SOC HD	1
40	1080547	PLUG - PIPE, 0.375, SST SOC HD	1
41	3606203	STUD - 0.375-16 x 1.500, GR5	12
42	5403002	NUT - HEX, .375-16, GR2	12
43	3605205	PIN - COTTER, .125 X 1.00, 316	1

REVISIONS				
ZONE	REV.	DESCRIPTION	DATE	APPROVED
HS	B	REDRAWN IN SOLIDWORKS	12/11/2020	12709 - WAH

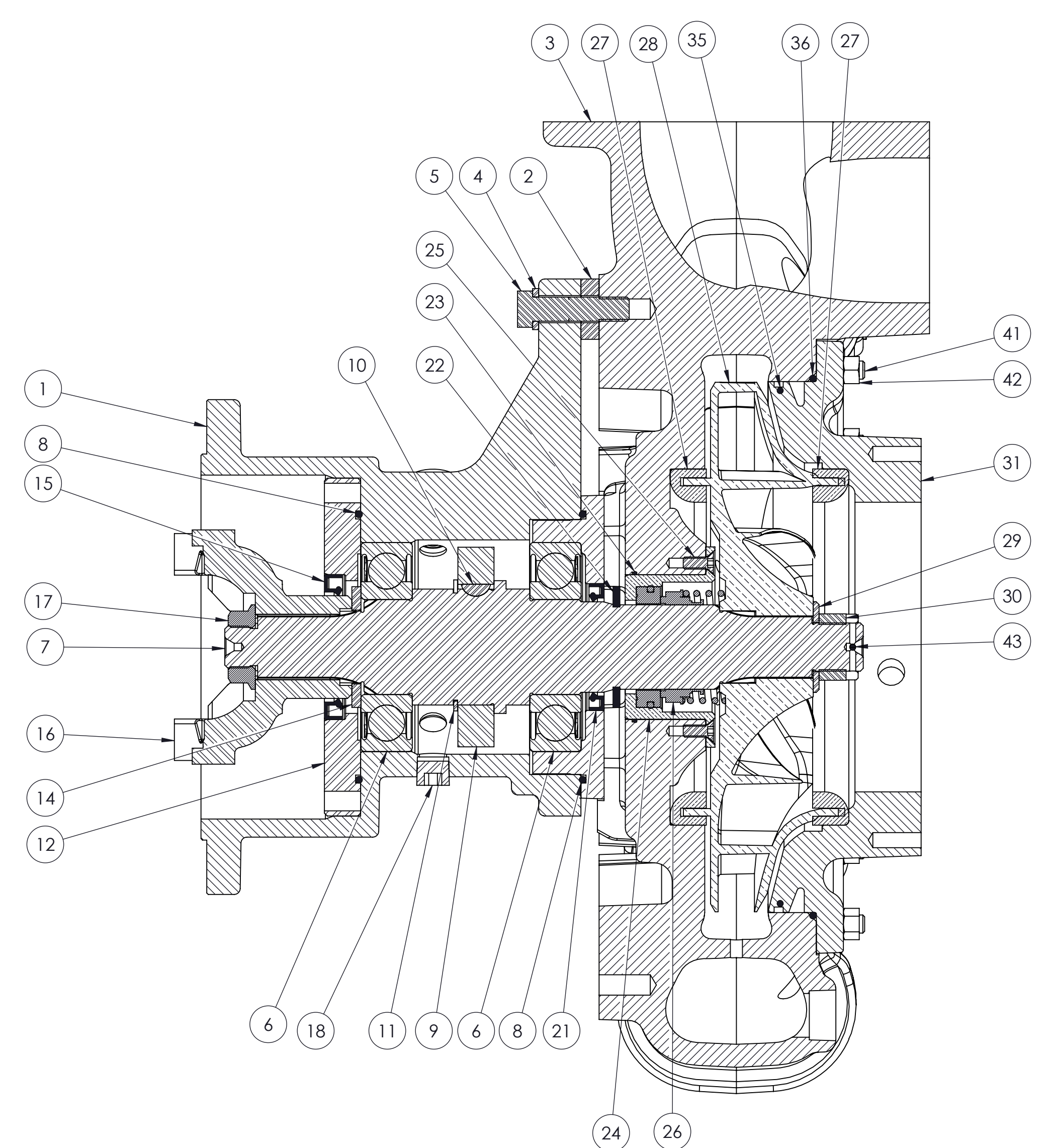

SECTION A-A

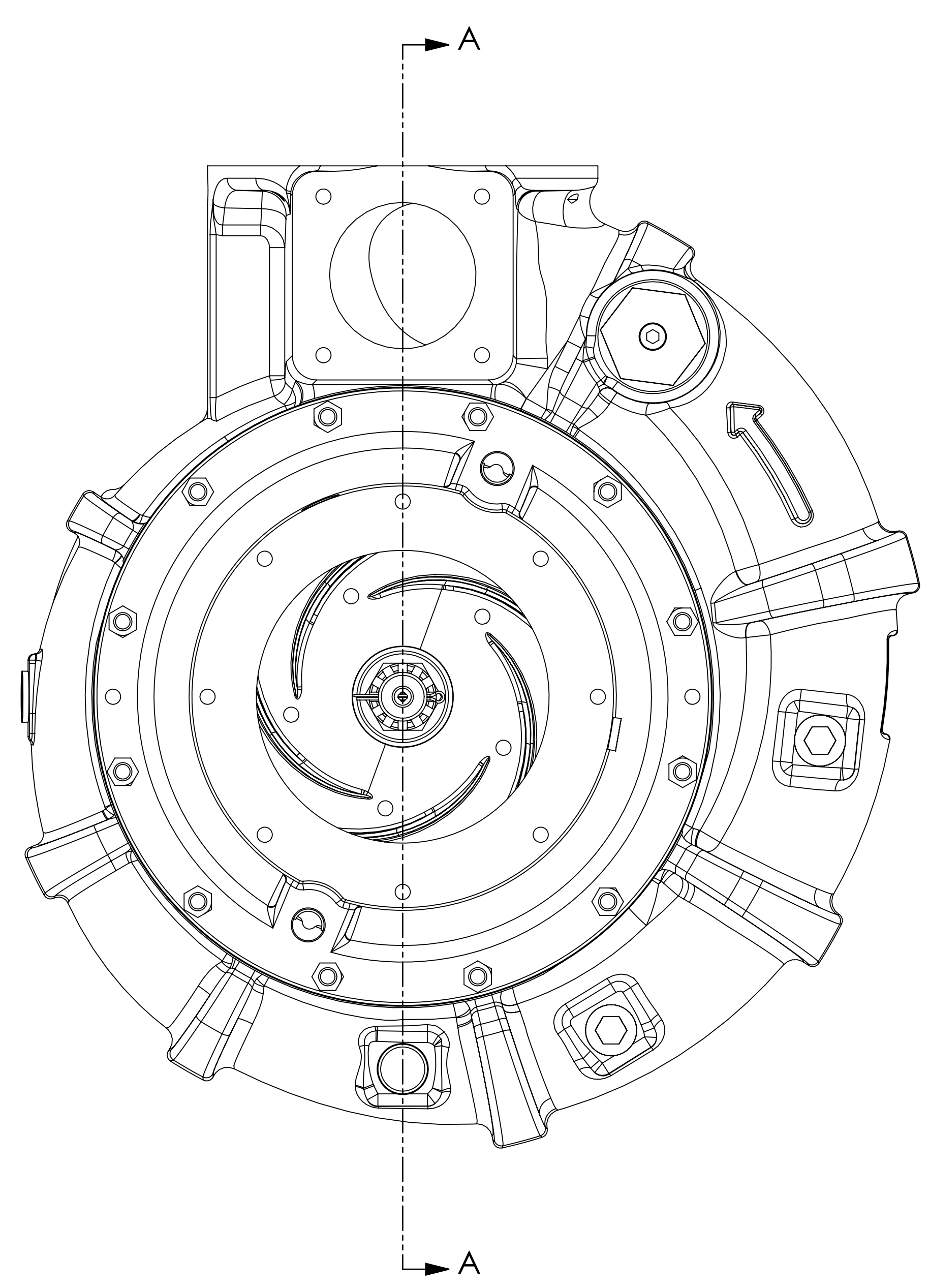

REMOVE SHARP EDGES		INCH [MILLIMETER]		THIRD ANGLE PROJECTION		MODEL		SHEET	
MATERIAL DESCRIPTION		MASS		OLD PART NO.		DPD1401		1/2 D	
259.22 LBS		259.22 LBS		PATTERN NO.		TOLERANCE EXCEPT AS NOTED		Darley ITASCA, IL CHIPPewa FALLS, WI	
THIS DESIGN IS THE PROPERTY OF WS. DARLEY CO. - UNAUTHORIZED REPRODUCTION IS PROHIBITED		ALL DIMENSIONS IN INCHES UNLESS NOTED		DRWN DWS/JJP		DATE: 29-JUL-10		DPC1601	
		DO NOT SCALE PRINT		TRCD WAH12/14/20		SCALE: 1:2			

ITEM NO.	File Name	Darley Item Description (Line 1)	QTY.
1	1805820	HOUSING - PSDE	1
2	3603016	FLAT WASHERS	3
3	2056901	PUMP CASING - PS, LG/STD EYE	1
4	3603533	WASHER - LOCK, 0.500 ID, SST	3
5	5400069	HHCS - .500-13 x 2.00, GR5	3
6	1722101	BEARING - BALL, 310SF	2
7	5022803	SHAFT - PSD NO CLUTCH	1
8	3601244	O-RING - 5.37 X 5.62 X 0.12	2
9	3206002	SLINGER - OIL, PSD, 2.402 ID	1
10	3602201	KEY - WOODRUFF, .605 (#61)	1
11	3600470	RING - RETAINER, 5100-237	1
12	2305181	RING - RETAINER, BEARING	1
13	5402845	HHCS - FLANGED, .375-16 X 1.00	4
14	3603932	WASHER - BEARING BACKUP	1
15	3600571	OIL SEAL - 2.125 X 3.00 OD	1
16	4817605	YOKE - 1.410, END, 1.50-10 SPL	1
17	4814501	NUT - FLANGE, 7/8-14	1
18	1080510	PLUG - PIPE, 0.375, MAG SOC HD	1
19	4401800	VENT - GEARCASE	1
20	1080541	PLUG - PIPE, 0.375, ZINC, SOCT	2
21	3600530	OIL SEAL - 1.875 ID x 2.627 OD	1
22	3203201	SLINGER - WATER, 1.661 ID	1
23	3601011	O-RING - 3.00 x 3.12 x 0.06	1
24	1840901	HOUSING - MECHANICAL SEAL, PS	1
25	5402402	FHMS - .250-20 X 0.63, SS SOCK	4
26	1845400	MECHANICAL SEAL - 1.75 WELD SPRG	1
27	3404205	SEAL RING - PS, LG EYE IMPELLER	2
28	2909600	IMPELLER - PS, R.H. 10.969 OD	1
29	3603328	WASHER - IMPELLER	1
30	5403447	NUT - CASTLE, 1-14, 303	1
31	2806606	HEAD - SUCTION, PS	1
32	1122400	SCREEN - STRAINER, 1.50"	1
33	1122300	STRAINER FITTING	1
34	3601401	O-RING - 1.47 X 1.71 X 0.09	1
35	3601228	O-RING - 10.50 X 10.75 X .14	1
36	3601220	O-RING - 11.00 x 11.25 x 0.12	1
37	1080533	PLUG - PIPE, .125, SST SOC HD	1
38	1080551	PLUG - PIPE, 0.750, SS SOC HD	3
39	1080535	PLUG - PIPE, .250, SS SOC HD	1
40	1080547	PLUG - PIPE, 0.375, SST SOC HD	1
41	3606203	STUD - 0.375-16 x 1.500, GR5	12
42	5403002	NUT - HEX, .375-16, GR2	12
43	3605205	PIN - COTTER, .125 X 1.00, 316	1

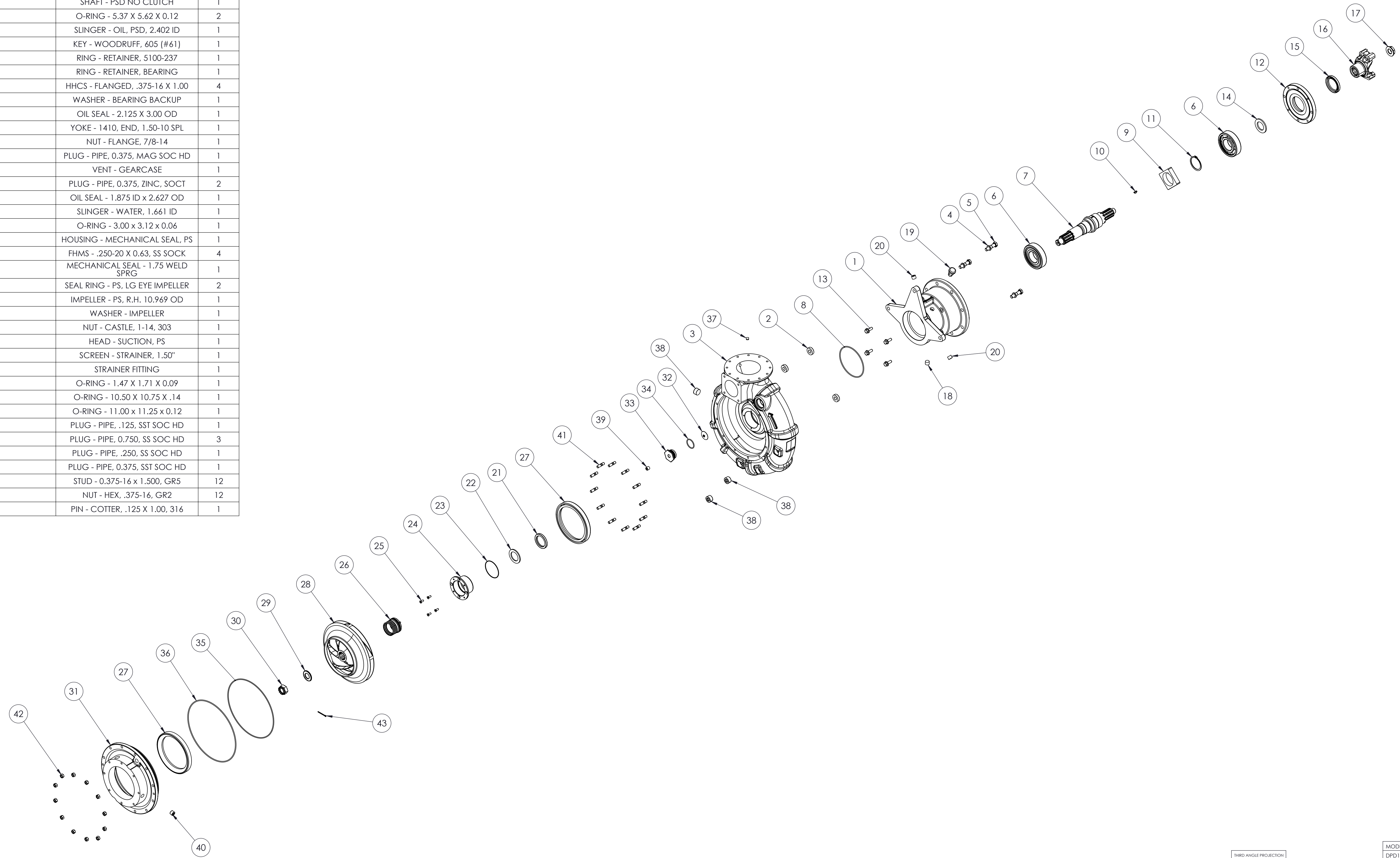

REMOVE SHARP EDGES		THIRD ANGLE PROJECTION		MODEL	SHEET
MATERIAL DESCRIPTION		OLD PART NO.		DPD1401	2/2
MASS		PATTERN NO.		D	
259.22 LBS		-		Darley ITASCA, IL CHIPPEWA FALLS, WI	
THIS DESIGN IS THE PROPERTY OF W.S. DARLEY CO. - UNAUTHORIZED REPRODUCTION IS PROHIBITED		DRWN DWS/JJP		DWG - PSD/NO CLUTCH	
ALL DIMENSIONS IN INCHES UNLESS NOTED		DATE: 29-JUL-10		DPC1601	
DO NOT SCALE PRINT		SCALE: 1:4		TRCD WAH12/14/20	