

2102523		3.12 X 7.5	3.125/3.113	7.5	2.910	2.50	2.63	DETROIT STANDARD
2102522			3.062/3.050	7	2.860	2.50	2.63	
2102520		SEE SEPARATE DRAWING						CHROME PLATED
2102519		SEE SEPARATE DRAWING						
2102518		SEE SEPARATE DRAWING						BRITISH COLUMBIA, CHROME
2102517		SEE SEPARATE DRAWING						CHROME PLATED
2102516	G2363A-16	SEE SEPARATE DRAWING						
2102515	G2363A-15	---	3.055/3.043	6	2.826	2.50	2.63	X4350 HIGBEE RING
2102514	G2363A-14	2 1/2 QST	3.031/3.019	7	2.814	2.50	2.63	X4349 HIGBEE RING
2102513	G2363A-13	---	3.030/3.018	8	2.820	2.50	2.63	
2102512	G2363A-12	---	3.188/3.176	6	2.915	2.50	2.63	
2102511	G2363A-11	2 1/2 BC	3.000/2.988	8	2.790	2.50	2.63	BRITISH COLUMBIA, FOR CHROME SEE 2102518
2102510	G2363A-10	---	3.068/3.056	8	2.858	2.50	2.63	
2102509	G2363A-9	2 1/2 BSP	2.960/2.955	11		2.38	2.50	BRITISH WHITWORTH FORM 55 - STRAIGHT THR'D OMIT HIGBEE
2102508	G2363A-8	2 1/2 NPT	2.875	8		2.50	2.63	OMIT HIGBEE
2102507	G2363A-7	---	3.230/3.215	5	2.907	2.50	2.63	NOVA SCOTIA - ZONE1
2102506	G2363A-6	---	3.250/3.238	6	2.980	2.50	2.63	
2102505	G2363A-5	---	2.990/2.978	8	2.780	2.50	2.63	Ø3.0167/Ø3.0068 OVER Ø.072 PINS 60° THREAD
2102504	G2363A-4	---	3.085	6	2.858	2.50	2.63	
2102503	G2363A-3	2 1/2 CSA	3.125/3.113	5	2.805	2.50	2.63	CANADIAN STANDARDS ASSOCIATION
2102502	G2363A-2	2 1/2 NPS	2.885/2.847	8		2.38	2.50	STRAIGHT PIPE THREAD - NO HIGBEE
2102501	G2363A-1	2 1/2 NH	3.068/3.056	7.5	2.850	2.50	2.63	
PART NO	OLD PART NO.	SIZE	A	B	C	D	M	REMARKS

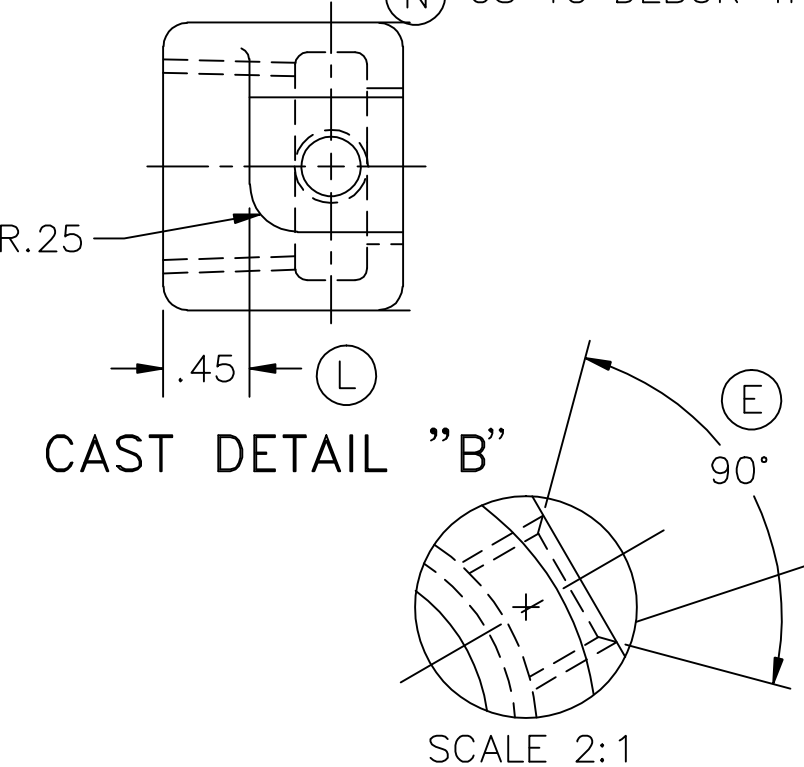

- NOTES:
- 1) BREAK SHARP EDGES
 - 2) REFER TO G2363B FOR NIPPLE WITH SUCTION SCREEN C'BORE
 - 3) REFER TO G2363C FOR DROOP NIPPLE WITH SWIVEL FITTING
 - 4) MOGUL IMPREGNATE AFTER MACHINING

N	ADDED COUNTER SINK	17JUL2006	2006-248	MWE
M	ADDED CHAMFER	17JUL2006	2006-248	MWE
MATERIAL:		81-3-7-9 CAST BRASS		
THIS DESIGN IS THE PROPERTY OF W.S. DARLEY AND CO. - UNAUTHORIZED REPRODUCTION IS PROHIBITED		ALL DIMENSIONS IN INCHES UNLESS NOTED		DO NOT SCALE PRINT
OLD PART NO.	G2363A	TOLERANCE EXCEPT AS NOTED	W.S. DARLEY & CO. MELROSE PARK, IL - CHIPPEWA FALLS, WI	
PATTERN NO.	G2363	FRAC DIM ±.01	NIPPLE - DISCHARGE 30 DEG.	
DR'N	SEITZ	DATE	OCT08,90	
CHKD		SCALE	1/1	
TRCD			2102500	

(L)	.45 WAS .53			
(K)	1.47 WAS 1.56	12/10/98	98-284	DL
(J)	.71 WAS .66			
(H)	60° WAS 45°			
(G)	CHGD CAST BOSS LOCATION- .66 WAS .58 1.56 WAS 1.63 .16 WAS 0.0	6/4/98	98-143	DL
(F)	ADDED CAST BOSS	1/9/98	98-06	DL
(E)	ADDED 90° CHAMFER	11/26/97	-	DLW
LTR	DESCRIPTION	DATE	CHG NO.	APPR'D