

W.S. Darley & Co.

TRUSTED WORLDWIDE SINCE 1908



Pump Plant & Engineering

1051 Palmer Street
Chippewa Falls, WI 54729
Phone 800-634-7812
Fax 715-726-2656

Pump Sales & Corporate

325 Spring Lake Dr.
Itasca, IL 60143-2072
Phone (708) 345-8050
Fax (708) 345-8993

Date: _____

Bill To: _____

P.O. No.: _____

Customer No.: _____

Order Completed By: _____

Desired Delivery Date: _____

End Customer: _____

Customer Contact:

Tel No.: _____

Fax No.: _____

Email: _____

Ship To: _____

PUMP ORDER FORM

HE PUMP

Please review the order form before starting. If any challenges arise, please call our Customer Service Department at (800) 634-7812 for assistance. We will be glad to help. Please fill in the information **completely**.

Rated capacity: GPM 250 350 500
 LPM 1000 1300 2000

*If special testing is required, please indicate your need.

Imperial Gallons (List Capacity) _____

Liters per Minute (List Capacity) _____

Other (Specify) _____

PUMP/ENGINE INFORMATION

Engine: _____

Color: _____

HP: _____

Altitude: _____ FT.

@ _____ RPM

Model: _____

Flywheel: _____

Flywheel Housing: _____

*If flywheel and housing are not SAE standard, complete form 1206001 and contact Darley engineering with information

PUMP RATING

NFPA 1901 Fire Pump

Other: _____

(Options, Fill in choices)

- Primary water type:** Salt water Fresh water
- Pump material:** Cast Iron Bronze (Recommended for salt water)
- Seal type:** Packing Mechanical Seal
- Electric Primer:** 12V 24V None
- Primer type:** Fluid Fluid-less

NST Suction Nipples, Screens, and Caps

- 3" (HE 350) 4" (HE 500)

Discharge Valves: (shipped loose)

- 2-1/2" NH Straight Nipple 2-1/2" NH 30° Down Nipple

Suction Valves: (shipped loose)

- 2-1/2" NH Female 2-1/2" NH Female "Full Flow"

- 3/4" **Valve Drains** (available on suction or discharge valves)

- Pressure Relief Valve with Remote Control and Pilot Light** (Shipped loose)

- Master Drain Valve (8 openings)**

- Isolated Ports Multiple Drain (6 openings)**

- Remote Packing Adjustment Cable**

- 2" Tubular Drive Shaft and 2 Universal Joints**

W.B. DORLEY & CO.

HE PUMP ORDER FORM

CHECK BOX FOR APPROPRIATE CHOICE OF EACH:

1. SUCTION FLANGE SIZE.
2. DISCHARGE FLANGE SIZE.
3. GEARCASE POSITION.

SUCTION INLET TYPE

- 4.0" NPT
- 4.0" BSPF
- 4.0" VIC
- OPTIONAL: 3 OPENING SUCTION HEAD
- 3.0" NPT
- 3.0" BSPF

FLANGE SIZE

- 2.5" NPT
- 2.5" BSP
- 3.0" NPT
- 3.0" BSP
- OPTIONAL: DISCHARGE HEAD

SUCTION HEAD THREAD ADAPTER OPTIONS:

- 4.0" BSPM ROUND THREAD
- 4.0" NST ADAPTER

BL 2.0 | 2.5 | 3.0 | 4.0

BL 2.0 | 2.5 | 3.0 | 4.0

BL 1.5 | 2 | 2.5 | 3
ELBOW (SEE BELOW)

BL 1.5 | 2 | 2.5 | 3
ELBOW (SEE BELOW)

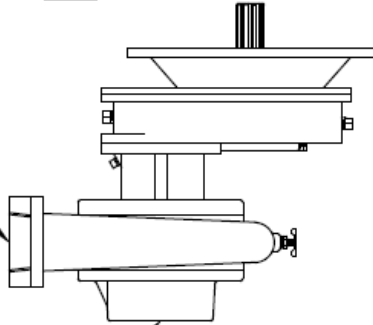

DISCHARGE HEAD OPENING ORIENTATION:



OPTIONAL: MOUNTED RELIEF VALVE
(REQUIRES DISCHARGE HEAD & 3 OPENING SUCTION HEAD)

OPTIONAL: DISCHARGE ELBOW (INDICATE LOCATION)

OPTIONAL GEAR CASE ORIENTATION
AS VIEWED FACING SUCTION INLET
SELECT ONE

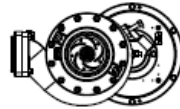

STANDARD POSITION

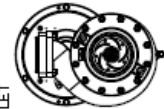

INPUT SHAFT ABOVE

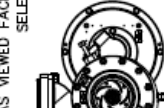

INPUT SHAFT RIGHT

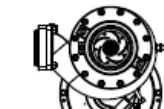

INPUT SHAFT LEFT

1202025
REV. 1
FEB 2009
AAN

(SEE PAGE 2 FOR MORE DISCHARGE OPTIONS)

W.B. DORLEY & CO.

HE PUMP ORDER FORM

CHECK BOX FOR APPROPRIATE CHOICE OF EACH:

1. SUCTION FLANGE SIZE.
2. DISCHARGE FLANGE SIZE.
3. GEARCASE POSITION.

OPTIONAL: DISCHARGE VALVE (INDICATE QTY)

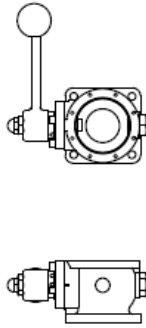

OPTIONAL: DISCHARGE NIPPLE (INDICATE QUANTITY AND LOCATION)

2 1/2" NH
3/4" NPT DRAIN TAP

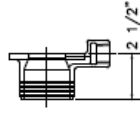

2 1/2" NH
3/4" NPT DRAIN TAP

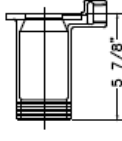

2 1/2" NH
3/4" NPT DRAIN TAP

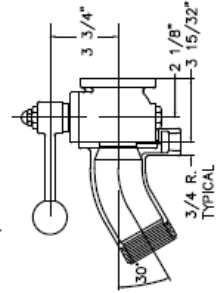

1200025
REV. 1
FEB 2009
AAAT

REV		DESCRIPTION		DATE		BY		CHK		APP											
<h1>HE VOLUTE ORIENTATION</h1>																					
CH1	STANDARD (DEFAULT)	CH2	DISCHARGE 100	CH3	DISCHARGE 200	CH4	DISCHARGE 300 (DISCHARGE RIGHT)	CH5	DISCHARGE 400	CH6	DISCHARGE 500										
CH7	DISCHARGE 600 (INVERTED) (DISCHARGE DOWN)	CH8	DISCHARGE 700	CH9	DISCHARGE 800	CH10	DISCHARGE 900 (DISCHARGE LEFT)	CH11	DISCHARGE 1000	CH12	DISCHARGE 1100 ONLY AVAILABLE WITH MECHANICAL SEAL										
<p>NOTE:</p> <ul style="list-style-type: none"> - OPTIONS #1, #4, #7, AND #10 ARE STANDARDLY AVAILABLE POSITIONS, ALL OTHER OPTIONS SHOWN ARE AVAILABLE AS A CUSTOM POSITION. - CUSTOM POSITIONS MAY REQUIRE ADDITIONAL LEAD TIME AND MAY REQUIRE AN ADDITIONAL FEE. - PUMP DRAIN MUST BE ADDED TO ALL POSITIONS THAT DO NOT ALLOW PROPER DRAINAGE THROUGH STANDARD PUMP DRAIN LOCATIONS OR THE PUMP DISCHARGE. 																					
										<table border="1"> <tr> <td>PROJECT NO.</td> <td>DATE</td> <td>BY</td> <td>CHK</td> <td>APP</td> </tr> <tr> <td></td> <td></td> <td></td> <td></td> <td></td> </tr> </table>		PROJECT NO.	DATE	BY	CHK	APP					
PROJECT NO.	DATE	BY	CHK	APP																	

Crating options/Instructions

- Standard Box
- Wood Crate, Bark Free
- Heat Treated Skid (Export)
- Oversized Domestic Skid and Box (38x44)
- Oversized Export Skid and Box (38x44)
- Oversized Heat Treated Skid (Export 38x44)
- Special Crating Instructions: _____

