

BALL VALVE QUARTER TURN - SELF LOCKING

The Darley Ball Valve is a quarter turn, all bronze valve designed for the fire service.

The ball is cast bronze, precision machined and hard chrome plated for long trouble free service. It is easily serviced in the field.

The lever is self locking and easily adjusted, even under extreme high pressure.

TO DISASSEMBLE AND REPAIR THE BALL VALVE ILLUSTRATION DGC0100

TOOLS REQUIRED:

- 3/16" Allen Wrench
- 1-1/8" Wrench
- 3/4" & 1" Wrench
- Vise Grips or Pliers

1. Remove cap nut (20) and adjusting nut (16).
2. Lever Assembly (11) pulls straight up. Watch for 2 cam balls (12).
3. Unbolt and remove clutch ring (9), clutch sleeve (8), valve stem (7), spring (14), and valve stem washer (15). Check clutch ring (9) and sleeve (8) for scoring or excessive wear. Check o-ring (26). Replace if necessary.
4. Remove nipple (2). Check Quad Ring (25). Replace if necessary.
5. Unscrew ball guide screw (6). Check o-ring (23). Replace if necessary.
6. Remove valve ball (3). Check for scratches, corrosion, and wear. Replace if necessary.
7. Remove seat assembly (4). Check condition of rubber seat. Replace seat assembly if necessary.

REASSEMBLY OF BALL VALVE ILLUSTRATION DGC0100

1. Position ball (3) in body so ball guide screw (6) engages bottom of ball as it is screwed into position.
2. Put valve stem (7) into position. Make certain stem engages slot on top of ball.
3. Slip washer (15), spring (14), and clutch sleeve (8) over the stem. Place clutch ring (9) over the sleeve and secure with the four (4) 1/4" NC x 5/8" socket head cap screws.
4. Set the two cam balls (12) into the V grooves in the clutch sleeve (8) and drop lever assembly over them. Tighten the adjusting nut (16) so that approximately 1/8" play is left at the end of a 6" lever. Over tightening this nut will make the clutch lock inoperative. Lock adjusting nut (16) with cap nut (20). Recheck this adjustment after valve is placed in service.
5. Place seat assembly (4), seat o-ring (5), and quad ring (25) into position.
6. Secure nipple (2) to valve body with eight (8) 1/4" NC x 5/8" socket head cap screws.

**If more information is needed, call W.S. DARLEY & CO. at
Chippewa Falls, WI at 800-634-7812 or 715-726-2650**

REP. NO.	NAME OF PART	QTY.
1	DISCHARGE VALVE BODY	1
2	VALVE NIPPLE	1
3	VALVE BALL	1
4	VALVE SEAT	1
5	O'RING	1
6	BALL GUIDE SCREW	1
7	VALVE STEM	1
8	CLUTCH SLEEVE	1
9	CLUTCH RING	1
10	LEVER CAM	1
11	FRONT MOUNT LEVER	1
12	CAM BALL	2
13	VALVE PIN	2
14	VALVE SPRING	1
15	VALVE STEM WASHER	1
16	ADJUSTING NUT	1
17	SPRING PIN-STL (A)	1
19	CONTROL LEVER BALL	1
20	CAP NUT	1
23	O'RING	1
25	QUAD RING	1
26	O'RING	1
27	O'RING	1
28	SOCKET HEAD CAP SCREW	4
29	SOCKET HEAD CAP SCREW	8

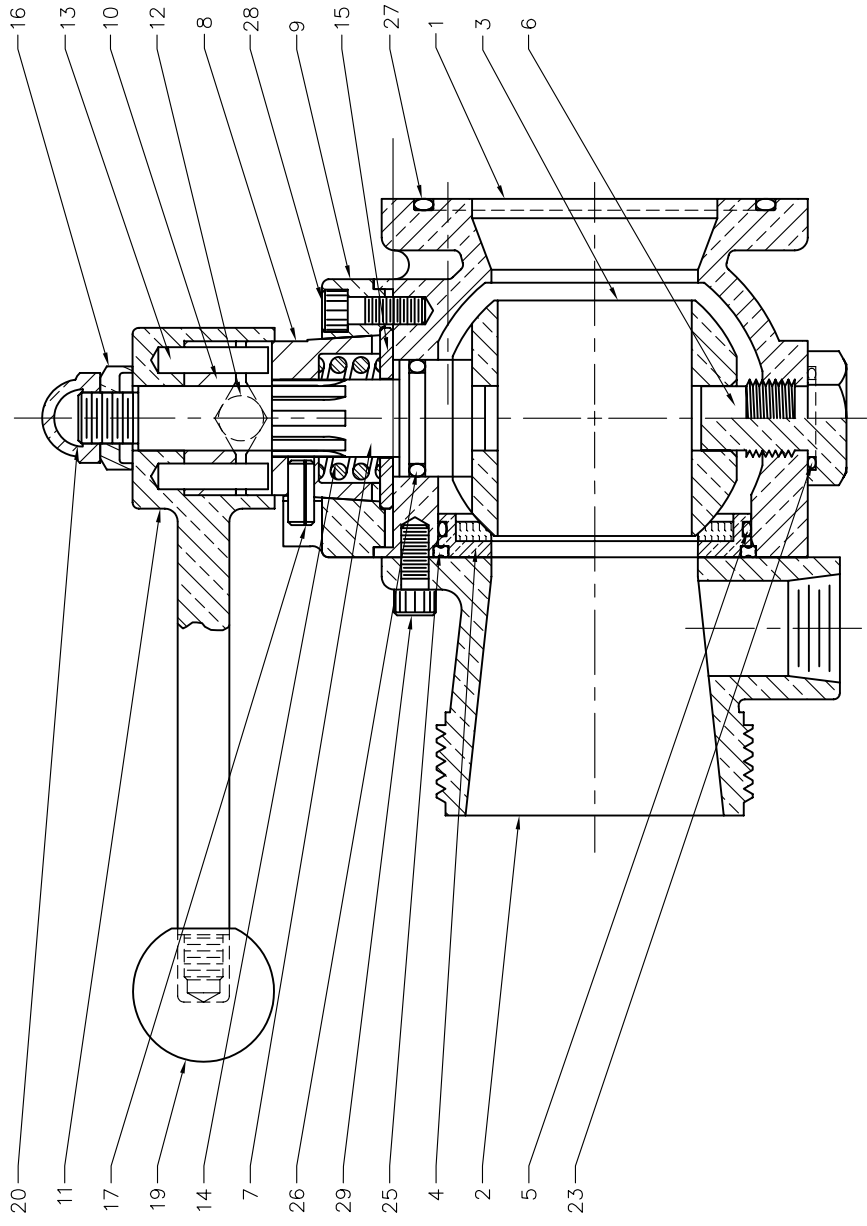

INCH
[MILLIMETER]

THIRD ANGLE PROJECTION

TOLERANCE
EXCEPT AS NOTED
DIMENSIONS IN INCHES
DECIMALS ±.010
ANGLES ±1°

W.S. DARLEY & Co.
MELROSE PARK, ILL. - CHIPPEWA FALLS, WI

DWG - BALL VALVE ASSEMBLY
CROSS SECTION

DATE NOV12,95
SCALE 1/1

DRN JCM
CHKD TRCDLHM 5/96

OLD PART NO. G1200

DO NOT SCALE PRINT

ALL DIMENSIONS IN INCHES UNLESS NOTED

THIS DESIGN IS THE PROPERTY OF W.S. DARLEY & CO. UNAUTHORIZED REPRODUCTION IS PROHIBITED

DGC0100