

REVISIONS				
LTNR	DESCRIPTION	DATE	CHG NO.	APPRD

REP NO.	NAME OF PART	QTY
1	Discharge Head Cap	1
2	Check Valve Bushing	1
3	O'Ring- Discharge Flange	2
4	Discharge Flange	2
5	Check Valve Plate	1
6	Brass Pin	1
7	Discharge Head	1
8	O'Ring - Cover	1
9	Relief Valve Outlet Cover	1
10	O'Ring - Strainer	1
11	Strainer	1
12	Strainer Fitting	1
13	Relief Valve Return Cover	1
14	O'Ring - Cover	1
15	Suction Head - Outboard	1
16	Stuffing Box Screw	6
17	Stuffing Box Closure	1
18	Shaft Seal	1
19	Water Seal	1
20	Bearing Cap	1
21	Bearing - Impeller Shaft	1
22	Oil Seal - Outboard	1
23	Water Slinger	1
24	O'Ring - Stuffing Box	2
25	Stuffing Box	1
26	1/8" NPT Plug	2
27	Drain Cock	1
28	O'Ring - Discharge Head Cap	1
29	Check Valve Stem	1
30	Hex Head Cap Screw	2
31	Check Valve Rubber	1
32	Check Valve Diffuser	1
33	Check Valve Seat	1
34	Gasket - Discharge Head	1
35	O'Ring - Relief Valve Elbow	1
36	Relief Valve Assembly	1
37	Relief Valve Elbow	1
38	Impeller	1
39	Impeller Seal Ring	2
40	Retaining Ring	2
41	Stuffing Box	1
42	Stuffing Box Closure	1
43	Water Slinger	1
44	Shaft Seal	1
45	Water Seal	1
46	Impeller Shaft	1
47	Oil Seal - Inboard	1
48	Stuffing Box Plug	2
49	O'Ring - Suction Head	2
50	Inboard Head	1
51	Gasket - Volute	2
52	Volute	1

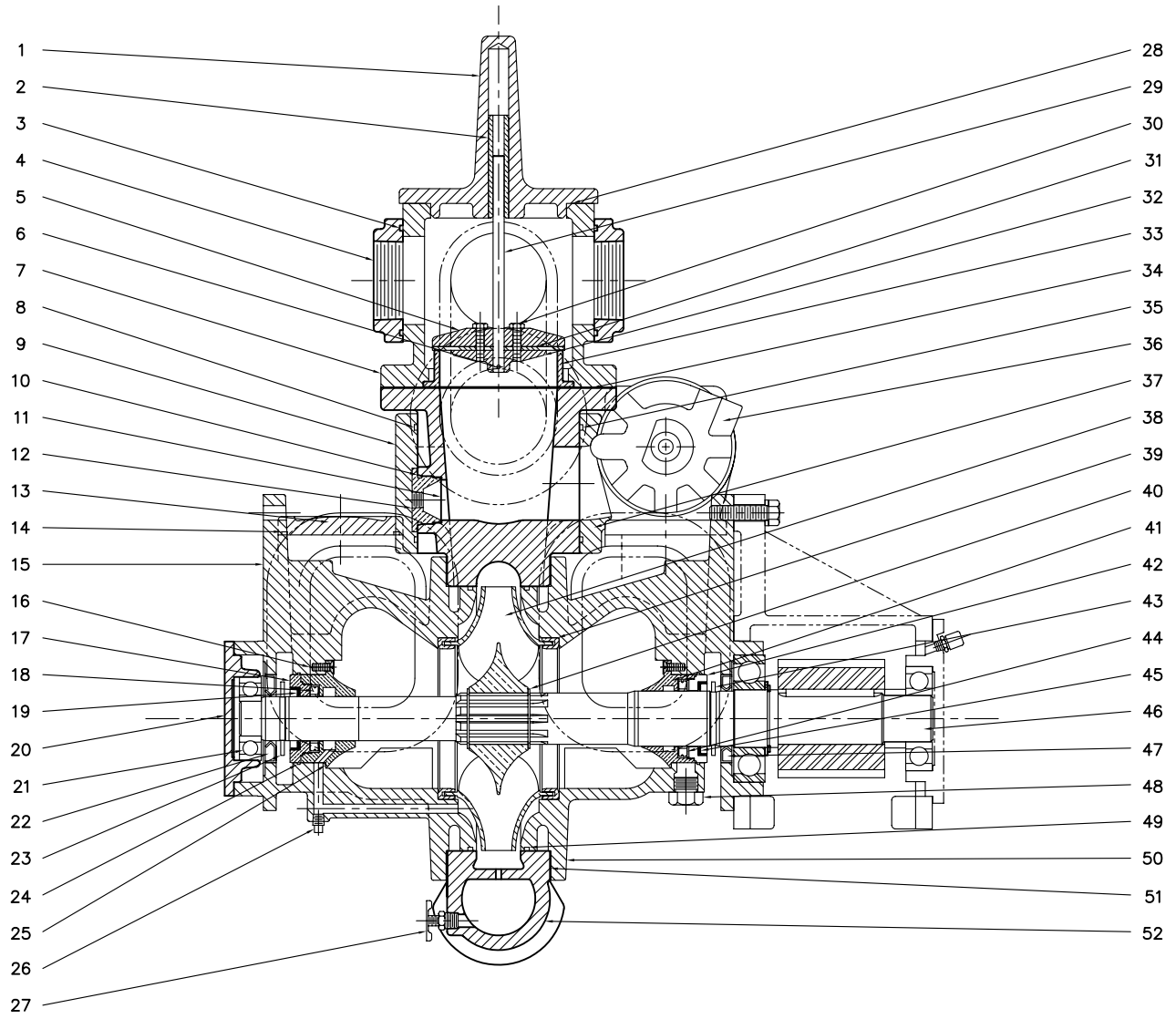

<b>TOLERANCE</b> EXCEPT AS NOTED .0008" FRACTIONAL .0005" DECIMAL .0001" ANGLES 90°	<b>W.S. DARLEY &amp; CO.</b> MICROSOFT PARK, N. CHESTER, PA. 15312
OLD PART NO. L135	DWG - LHM PUMP ASSM, MECH SEAL CROSS SECTION
DWN. S. LEE CHKD TRCD WWV	DATE NOV30,94 SCALE 1/2

**DLC0102**