

REV	DATE	DESCRIPTION	BY
A	9/1/2023	INITIAL RELEASE	KGH
B	2/26/2024	UPDATED PUMP PANEL, STANDARD OPTIONS, & DIMERS	KGH

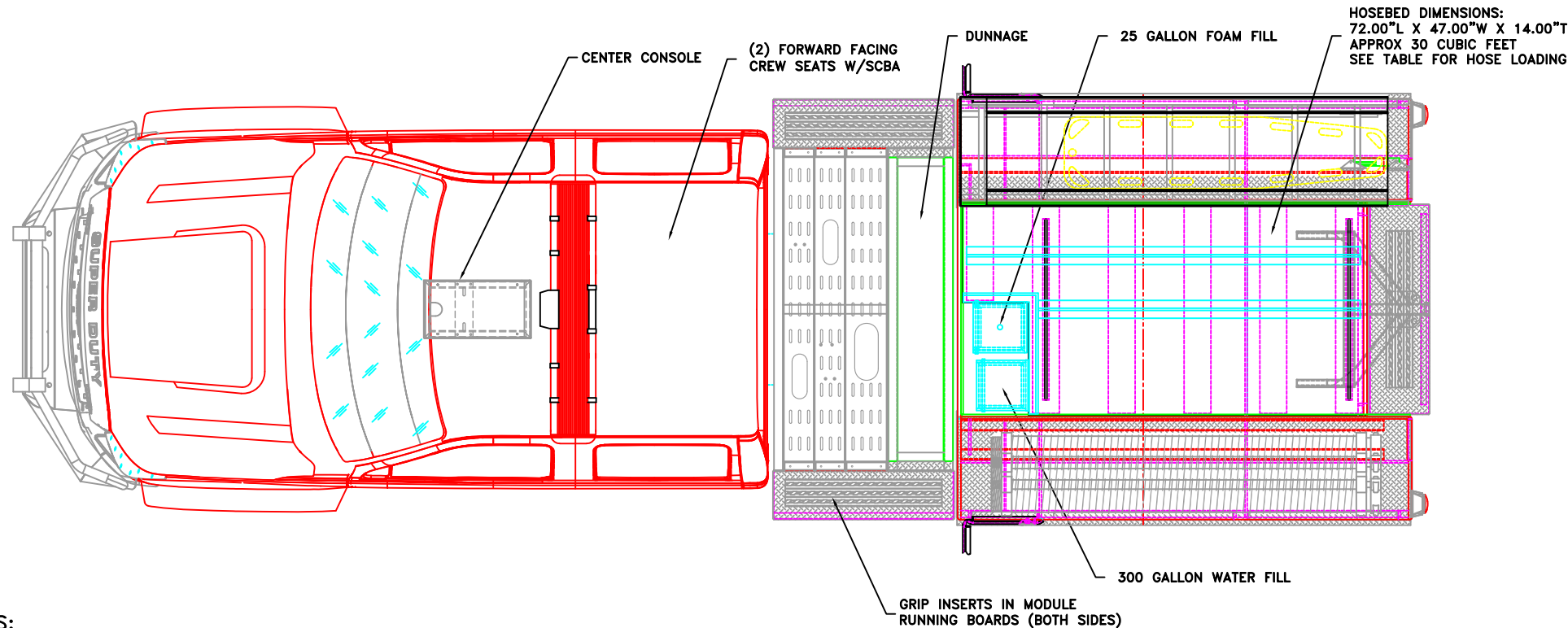
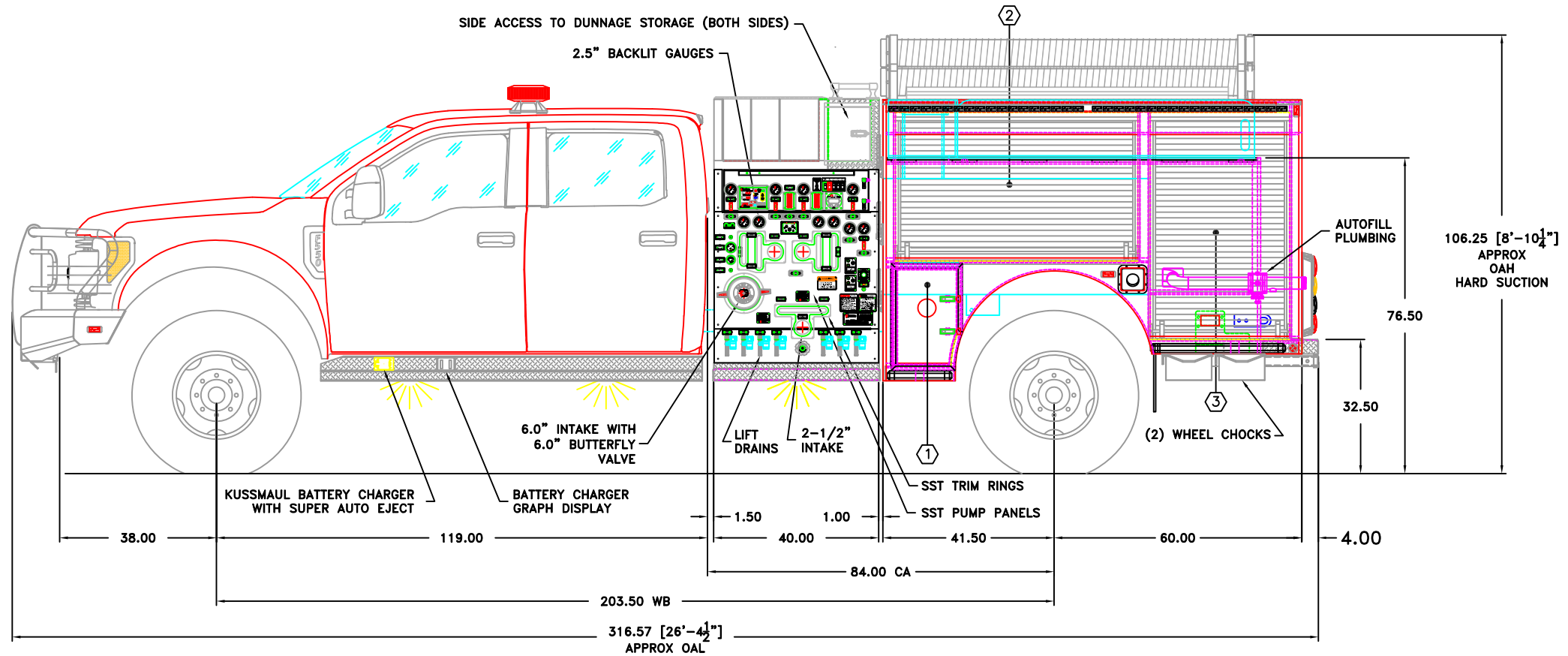

HOSE BED CAPACITIES:
 1400 FT OF 2.0" HOSE
 1050 FT OF 2.5" HOSE
 850 FT OF 3.0" HOSE
 500 FT OF 5.0" HOSE

CHASSIS		
MODEL	GVW 19,500	
FORD F-550	FRONT AXLE 7,500 REAR AXLE 14,706	
4 X 4	C/A 84.00 WB 203.50	
	ENG. TYPE 6.7L POWERSTROKE DIESEL	
PUMP TYPE PSMC 1500 GPM SINGLE STAGE		
TANK SIZE/TYPE 300 GAL WATER 25 GAL FOAM / POLY		
COMPARTMENTS		
MARK	SIZE	DOOR SIZE
1	15.25W X 23.88H X 20.50D	PAN DOOR
2	58.75W X 36.00H X 20.50D	58.75W X 34.00H
3	33.75W X 55.00H X 20.50D	33.75W X 53.00H

GENERAL NOTES

These drawings are the sole property of W.S. DARLEY & Co. These Drawings are for showing the concept of the apparatus being specified and therefore may not agree with the final contract.

Not all items being specified are shown on these drawings. Refer to specifications for further details.

These drawings are on loan and must be returned upon request of W.S. DARLEY & Co. or its authorized representative.

This design is the property of W.S. DARLEY & Co. - unauthorized reproduction is prohibited.

Chassis is Manufacturer's standard production model. Specifications are subject to change without notice.

Dimensions shown are approximate, and subject to minor deviations as may occur or be necessary in construction. Minor details not shown. Where there may be nonconformity between the illustration and the sales order, the sales order and all approved sales order changes will prevail.

DO NOT SCALE PRINTS

All dimensions shown are in decimal inches unless noted otherwise.

ABBREVIATIONS

COMMONLY USED ABBREVIATIONS IN DRAWINGS:

A/F - AFT FRAME	COMP. - COMPARTMENT
W.B. - WHEEL BASE	
C/A - CAB TO AXLE	
OAL - OVERALL LENGTH	
OH - OVERALL HEIGHT	
GVW - GROSS VEHICLE WEIGHT	
TYP. - TYPICAL	
C.S. - CUSTOMER SUPPLIED	
N.I.C. - NOT IN CONTRACT	

PROJECT

MAX F550 TACTICAL PUMPER™

for

W.S. DARLEY
 CHIPPEWA FALLS, WI

W.S. Darley & Co.
 APPARATUS DIVISION
 920 KURTH ROAD
 CHIPPEWA FALLS, WISCONSIN 54729
 1-715-726-2645

CUSTOMER APPROVAL SIGNATURE	DATE	REVISIONS
DARLEY APPROVAL SIGNATURE	DATE	DATE FEBRUARY 26, 2024
		SCALE 3/4" = 1'-0"
		QW BASE SPEC
		DRN K. HALOPKA
		CHKD C. FEUSTER
		DWG FILE NAME 13001004
		JOB NO. MAX F550
		SHEET NO. 1

REV	DATE	DESCRIPTION	BY
A	9/1/2023	INITIAL RELEASE	KGH
B	2/26/2024	UPDATED PUMP PANEL, STANDARD OPTIONS, & DIMERS	KGH

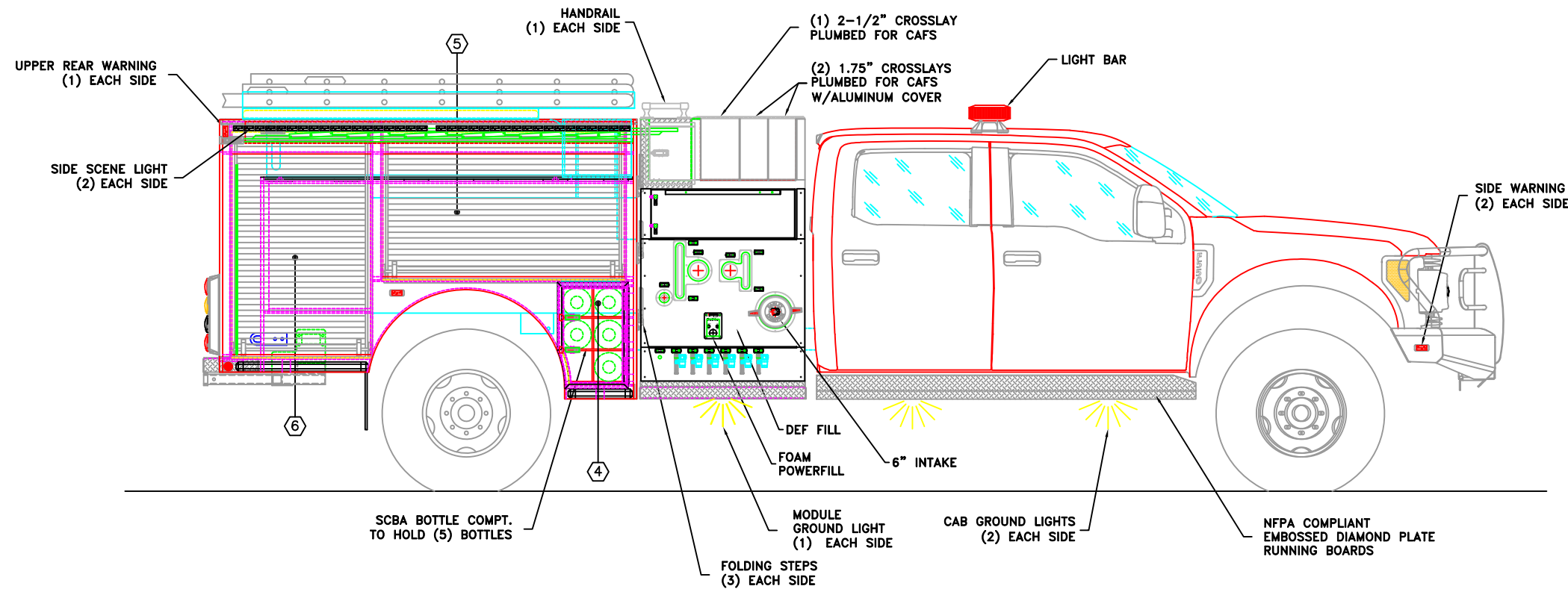

CHASSIS

MODEL	FORD		G/W	19,500
F-550	FRNT AXLE	7,500	REAR AXLE	14,706
4 X 4	C/A	84.00	WB	203.50
	ENG. TYPE	6.7L POWERSTROKE DIESEL		

PUMP TYPE PSMC 1500 GPM SINGLE STAGE
TANK SIZE/TYPE 300 GAL WATER 25 GAL FOAM / POLY

COMPARTMENTS

MARK	SIZE	DOOR SIZE
4	15.25W X 23.88H X 20.50D	PAN DOOR
5	58.75W X 36.00H X 20.50D	58.75W X 34.00H
6	33.75W X 55.00H X 20.50D	33.75W X 53.00H
7	42.00W X 28.63H X 24.75D	42.00W X 26.63H

DRAWING NOTES

DIMENSIONS SHOWN ARE APPROXIMATE AND ARE SUBJECT TO MINOR DEVIATIONS DURING CONSTRUCTION NOT ALL ITEMS SPECIFIED ARE ON THIS PRINT

BODY CONSTRUCTION -
REAR DOORS -
SIDE DOORS -
DOOR HANDLES -
DOOR STAYS VERTICAL -
DOOR STAYS HORIZONTAL -
COMPARTMENT INTERIORS -
PUMP PANEL FINISH -
OPERATORS PANEL -
LIGHT BAR TYPE -
LIGHT BAR LOCATION -
REAR BEACONS -
SPOT LIGHTS REAR -
SPOT LIGHTS FRONT -
SCENE LIGHTS TYPE -
SCENE LIGHT LOCATIONS -

UNDER BODY LIGHTS -
REAR SIDE LIGHTS -
INTERSECTION LIGHTS -
AIR HORNS -
SIREN/SPEAKER TYPE -
SIREN/SPEAKER LOCATION -
GENERATOR TYPE -
GENERATOR LOCATION -

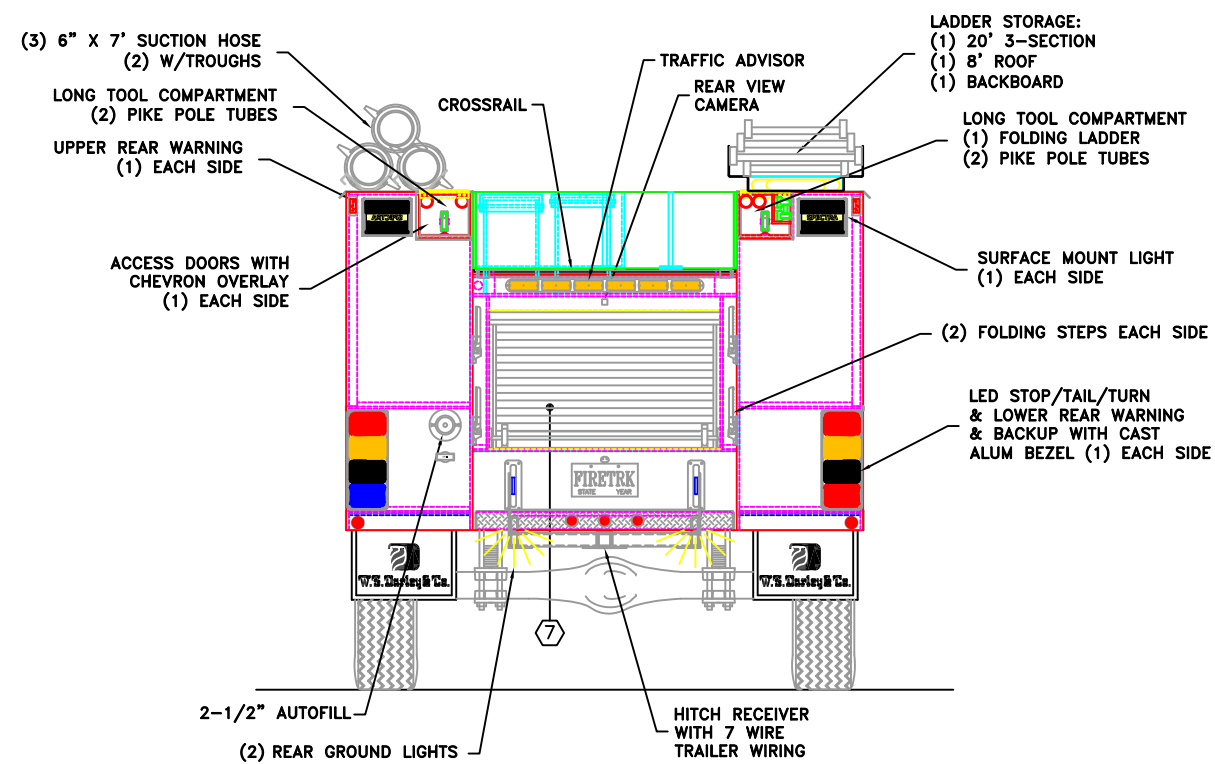

- 6'-0"
- 5'-6"
- 5'-0"
- 4'-6"
- 4'-0"
- 3'-6"
- 3'-0"
- 2'-6"
- 2'-0"
- 1'-6"
- 1'-0"
- 0'-6"
- 0'-0"

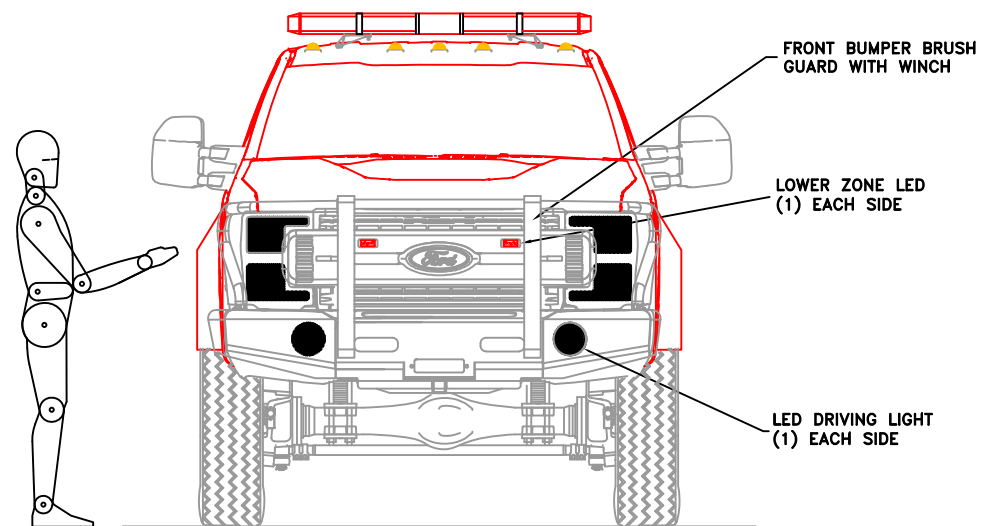

CUSTOMER APPROVAL SIGNATURE	DATE
THIS DESIGN IS THE PROPERTY OF W.S. DARLEY AND CO. - UNAUTHORIZED REPRODUCTION IS PROHIBITED.	ALL DIMENSIONS IN INCHES UNLESS NOTED
DO NOT SCALE PRINT	

PROJECT
MAX F550 TACTICAL PUMPER™
for
W.S. DARLEY
CHIPPEWA FALLS, WI

W.S. Darley & Co.
APPARATUS DIVISION
920 KURTH ROAD
CHIPPEWA FALLS, WI 54729
1-715-726-2645

DATE FEBRUARY 26, 2024
SCALE 3/4" = 1'-0"
QW BASE SPEC

DRN: K. HALOPKA
CWO: C. FEUSTER
DWG FILE NAME: 13001004

REVISIONS

JOB NO. MAX F550
SHEET NO. 2